

A1 in Northumberland: Morpeth to Ellingham

Scheme Number: TR010059

7.6A Statement of Common Ground with Northumberland County Council

Rule 8 (1)(e)

Planning Act 2008

Infrastructure Planning (Examination Procedure) Rules 2010

July 2021

Infrastructure Planning

Planning Act 2008

**The Infrastructure Planning
(Examination Procedure) Rules
2010**

**The A1 in Northumberland: Morpeth to
Ellingham**

Development Consent Order 20[xx]

**Statement of Common Ground with
Northumberland County Council**

Rule Reference:	8(1)(e)
Planning Inspectorate Scheme Reference:	TR010059
Doc Reference:	7.6A
Author:	A1 in Northumberland: Morpeth to Ellingham Project Team, Highways England

Version	Date	Status of Version
Rev 10	July 2021	Deadline 11

STATEMENT OF COMMON GROUND

This Statement of Common Ground has been prepared and agreed by (1) Highways England Company Limited and (2) Northumberland County Council

Signed

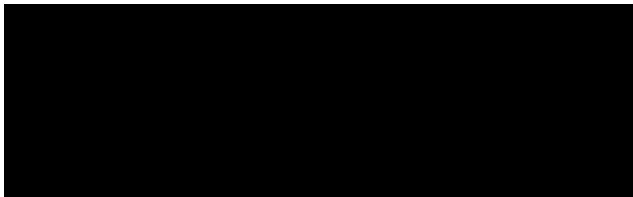

Mark Stoneman, Project Manager on behalf of Highways England

Date: 2nd July 2021

Signed

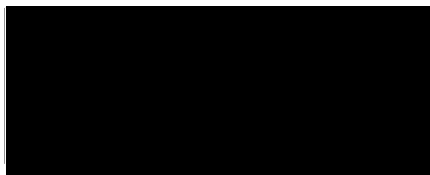

Katherine Robbie, Senior Planner on behalf of Northumberland County Council

Date: 2nd July 2021

CONTENTS

1	INTRODUCTION	1
1.1	PURPOSE OF THIS DOCUMENT	1
1.2	PARTIES TO THIS STATEMENT OF COMMON GROUND	2
1.3	TERMINOLOGY	2
2	RECORD OF ENGAGEMENT	3
3	ISSUES	47

TABLES

Table 2-1 – Record of Engagement in Relation to the Whole Scheme	4
Table 2-2 - Record of Engagement in Relation to Part A	29
Table 2-3 – Record of Engagement in Relation to Part B	40
Table 3-1 – Issues Related to the Draft Development Consent Order	47
Table 3-2 – Issues Related to the Scheme	50

APPENDICES

APPENDIX A

PEDESTRIAN - CYCLE LINK MORPETH TO FELTON

1 INTRODUCTION

1.1 PURPOSE OF THIS DOCUMENT

- 1.1.1. This Statement of Common Ground (SoCG) relates to an application made by Highways England (the “Applicant”) on 7 July 2020 to the Secretary of State (SoS) for Transport via the Planning Inspectorate (the “Inspectorate”) under the Planning Act 2008 (the “2008 Act”) for a Development Consent Order (DCO). The DCO was accepted for examination by the Inspectorate on 4 August 2020.
- 1.1.2. If made, the DCO would grant consent for the A1 in Northumberland, Morpeth to Ellingham (the “Scheme”). The Scheme is formed of two parts as follows: A1 Morpeth to Felton (Part A) and A1 Alnwick to Ellingham (Part B). A detailed description of the Scheme can be found in Chapter 2: The Scheme of the Environmental Statement (ES) (APP-037).
- 1.1.3. This SoCG does not seek to replicate information which is available elsewhere within the Application documents. All documents are available on the Inspectorate website:
<https://infrastructure.planninginspectorate.gov.uk/projects/North%20East/A1-in-Northumberland---Morpeth-to-Ellingham/>
- 1.1.4. The SoCG has been produced to confirm to the Examining Authority where agreement has been reached between the parties to it and where agreement has not (yet) been reached. SoCGs are an established means in the planning process of allowing all parties to identify and so focus on specific issues that may need to be addressed during the examination.
- 1.1.5. This SoCG seeks to address the issues identified by the ExA in the Rule 6 Letter dated 19 November 2020, namely:
- a.** Development Consent Order;
 - b.** Economic and Social effects (to the extent that it is relevant to the application, planning policy is also addressed in this section);
 - c.** Environmental Impact Assessment, including issues related to:
 - d.** Cumulative effects;
 - e.** Noise and disturbance (including construction and operational);
 - f.** Landscape and visual impact;
 - g.** Historic environment;
 - h.** Design;
 - i.** Air quality;
 - j.** Ecology, habitats and nature conservation effects;
 - k.** Traffic and transport;
 - l.** Effects on motorised road traffic;
 - m.** Effects on the Public Rights of Way (PRoW) network and on cyclists, pedestrians and horse riders;
 - n.** Construction Environmental Management Plan.

1.2 PARTIES TO THIS STATEMENT OF COMMON GROUND

- 1.2.1. This SoCG has been prepared by (1) Highways England as the Applicant and (2) Northumberland County Council (NCC).
- 1.2.2. Highways England became the Government-owned Strategic Highways Company on 1 April 2015. It is the highway authority in England for the strategic road network and has the necessary powers and duties to operate, manage, maintain and enhance the network. Regulatory powers remain with the SoS. The legislation establishing Highways England made provision for all legal rights and obligations of the Highways Agency, including in respect of the Application, to be conferred upon or assumed by Highways England.
- 1.2.3. NCC is the Local Authority for the Scheme falling within Category A of section 43(1) of the 2008 Act and is both the local planning authority and highway authority for the Scheme which falls entirely within the Council's administrative area.

1.3 TERMINOLOGY

- 1.3.1. In the tables in the Issues section of this SoCG, "Not Agreed" indicates a final position, and "Under discussion" indicates where these points will be the subject of on-going discussion wherever possible to resolve or refine, the extent of disagreement between the parties. "Agreed" indicates where the issue has been resolved.
- 1.3.2. It can be taken that any matters not specifically referred to in the Issues section of this SoCG are not of material interest or relevance to NCC, and therefore have not been the subject of any discussions between the parties. As such, those matters can be read as not being in dispute, to the extent that they are either not of material interest or relevance to NCC in the determination of the Application.

2 RECORD OF ENGAGEMENT

- 2.1.1. This Chapter provides a summary of the engagement to date between the Applicant and NCC in relation to the Scheme.
- 2.1.2. Any engagement with NCC in relation to the Scheme as a whole is recorded in Table 2-1, below. It should be noted that it was originally envisaged that Part A and Part B would be pursued as separate DCO applications. Any engagement with NCC that solely relates to either Part A or Part B is therefore recorded Tables 2-2 and 2-3, respectively.

Table 2-1 – Record of Engagement in Relation to the Whole Scheme

Date	Form of Correspondence	Key Topics Discussed and Key Outcomes
18/01/18	Meeting between NCC and Highways England.	<p>Key Topics Meeting held with NCC to provide an update on the progression of separate DCOs for Part A and Part B.</p> <p>Key Outcomes NCC was made aware of the proposal at this stage being to progress Part A and Part B as two separate DCO applications.</p>
24/05/18	Meeting between NCC and Highways England.	<p>Key Topics The Applicant tabled typical scheme highway cross-sections on the Scheme.</p> <p>Key Outcomes The typical cross sections were debated, and high-level traffic management principles discussed with NCC.</p>
26/06/18	Highways Departures from Standards (DfS) design meeting between NCC and Highways England	<p>Key Topics Meeting to discuss the approach / design rationale for the side road designs, including design speed, carriageway widths, radii and Stopping Sight Distances (SSD). NCC set out materials required for their approval.</p> <p>Key Outcomes Agreed design speeds, using Highways England's TD9 from Design Manual for Roads and Bridges (DMRB). NCC agreed formal DfS could be generic for items associated with all side roads. HE to investigate design options for free-flow link at Fenrother. NCC stated same approach for all side road layouts. Materials for NCC to be consulted on at detailed design are:</p> <ul style="list-style-type: none"> – Highway Side Road Layout Drawings; – Schedule of Side Road Departures; – Comprehensive side road drainage information, including calculations; – Detailed structural designs on side roads; – Side Road Traffic Sign Details.
31/07/18	Meeting between NCC and Highways England	<p>Key Topics Meeting held to discuss the maintenance boundaries for the Scheme based on records held by Highways England.</p> <p>Key Outcomes Traffic Management Principles raised by NCC at previous meeting of 24/05/18 now agreed Maintenance at bridges still being reviewed.</p>

Date	Form of Correspondence	Key Topics Discussed and Key Outcomes
22/08/18	Meeting in Northumberland County Hall, Historic England, Karen Derham (NCC County Archaeologist) and Glenn Shaw (NCC Buildings Conservation Team)	<p>Key Topics</p> <p>Part A</p> <p>For Part A, the meeting included a review of the Historic Environment Desk-based Assessment (Part A), which included the results of the geophysical survey LiDAR assessment.</p> <p>Key Outcomes</p> <p>NCC confirmed they were satisfied with the content and agreed that no further assessments would be undertaken prior to DCO submission.</p> <p>Part B</p> <p>Key Topics</p> <p>In relation to Part B the meeting outlined the route and the purpose was to identify and discuss any immediate concerns about heritage assets within and adjacent to Part B. Issues associated with the Scheduled Monuments within and adjacent to the Scheme were discussed.</p> <p>Key Outcomes</p> <p>It was agreed to review the potential impacts following completion of the geophysical survey.</p>
23/10/18	Email exchange between Highways England and NCC Ecologist	<p>Key Topic</p> <p>Email exchange regarding the scope of the air quality assessment with regards to designated sites. Highways England stated that the relevant Design Manual for Roads and Bridges (DMRB) guidance (HA 207/07) does not include local wildlife sites in the assessment criteria. A comment from the Planning Inspectorate states that “The need to consider ... sensitive nature conservation sites should be established through consultation with the relevant statutory consultees” and therefore comment was requested from NCC.</p> <p>Key Outcome</p> <p>NCC confirmed that they firmly believe that Local Wildlife Sites should be included as part of the air quality assessment.</p>
29/11/18	Core Responder Engagement meeting including NCC’s Northumberland Fire and Rescue.	<p>Key Topics</p> <p>Introductory meeting to both Parts A and B, existing emergency access procedures, existing operational, enforcement/compliance and heightened situations challenges.</p>

Date	Form of Correspondence	Key Topics Discussed and Key Outcomes
		<p>Key Outcomes</p> <p>Confirmed enforcement cameras are not live and Agreed that they are not required. Hardstanding platforms not required and Agreed will use proposed laybys. Construction sequence for Parkwood subway to have bespoke emergency access plans shared through Highways England liaison officer. Diversion routes to be issued through same process.</p> <p>It was Agreed that, at detailed design, Highways England would explore opportunities for funding (through the rural crime prevention fund) for the provision of automatic number plate recognition (ANPR).</p>
06/12/18	Meeting between NCC and Highways England.	<p>Key Topics</p> <p>Meeting to further discuss the maintenance boundaries for the Scheme</p> <p>Key Outcomes</p> <p>NCC Agreed to consider the maintenance boundary technical note that was previously shared with NCC on 29/11/18. (Maintenance boundaries Technical Notes included as TT.3 in response to First Written Questions [REP1-032]). Agreement on details to be reached at future meetings.</p> <p>The meeting also discussed planning related matters with respect to proposals for development by Millhouse (within Part A) and Northumberland Estates (within Part B) and latest NCC activities on these matters. NCC undertook to seek legal advice on the Certificate of Lawfulness for the Millhouse planning permission, and to review the Parish Council review of the Denwick Bypass proposals from Northumberland Estates. NCC has subsequently confirmed their view that the Millhouse planning permission is not extant and therefore not capable of implementation [REP3-029].</p>
09/12/20	Call between NCC and drainage specialist.	<p>Key Topics</p> <p>Call to discuss surface water drainage strategy for the Scheme</p> <p>Key Outcomes</p> <p>NCC stated that the Applicant had not produced plans showing drainage catchments in detail. This was discussed with NCC, and the Applicant highlighted that it has provided plans at Appendix B of Appendix 10.5 Drainage</p> <p>Strategy Report Part A [APP-258] and Appendix B of Appendix 10.4 Drainage Strategy Report Part B [APP-314] which show the different surface water catchments by identifying the highway drainage networks that connect to each of the detention features and subsequent outfalls to watercourses. NCC Agreed with this approach and this was confirmed in an email to NCC which was issued on 22nd December 2020.</p> <p>The existing ground conditions and their unsuitability for infiltration means that it is not reasonably practicable to comply with S4 with this Scheme. As a result, the Applicant has considered S6 which gives guidance when S4 cannot be complied with. (S6 Where it is not reasonably practicable to constrain the volume of runoff to any drain, sewer or surface water body in accordance with S4 or S5 above, the runoff volume must be discharged at a rate that does not adversely affect flood risk.) NCC confirmed that this approach is satisfactory.</p>

Date	Form of Correspondence	Key Topics Discussed and Key Outcomes
05/01/21	Telephone conversation with Mary Fisher (NCC) and Andy Williams (on behalf of Highways England)	Key Topics and Outcome Discussion over landscape and visual impacts. WSP set out the position of the Applicant and NCC responded on a without prejudice basis.
6/1/21	Email exchange with Mary Fisher, and Andy Williams (on behalf of the Applicant)	Key Topic Email exchange regarding the design of the Coronation Avenue (number, spacings and frequency). Reference to further discussion with NCC tree officer to also get feedback. Key Outcome Email received from NCC confirming that they are in agreement with the proposed replacement strategy for the Coronation Avenue, as per Appendix LV.2 to Written Question LV.1.8 at Deadline 1 [REP1-032].
07/01/21	Call between NCC and drainage specialist.	Key Topic and Outcome Follow up call to discuss surface water drainage strategy for the Scheme.
14/01/21	Meeting with NCC and the Applicant	Detailed discussion around issues identified with the Rights of Way and Access Plans and DCO Schedules. Key Topic NCC stated that it was unclear from the DCO plans which roads are to be adopted and which are not. NCC also requested clarification as to the extents of stopping up of the existing A1 at the southern end of the detrunking section, at Priest's Bridge. NCC believe stopping up of highway should continue further south than is shown on the Rights of Way and Access Plans. NCC stated that the extent of soft estate to be adopted is unclear, with respect to earthworks, verge, landscaping and detention basins. Key Outcome A scheme overview plan showing the extent of roads to be adopted was produced and issued to NCC on 08/02/21. Extents of stopping up of the existing A1 at the southern end of the detrunking section, at Priest's Bridge, amended as per NCC's suggestion. Updated Rights of Way and Access Plans issued at Deadline 02. [REP2-003]. The Applicant is unable to confirm exact limits of soft estate to be adopted at present. Such details are subject to detailed design, with the exception of the detention basins for adoption which can and will be confirmed.
15/01/21	Skype Meeting between Katherine Robbie (NCC), David Green, Nic Macmillan, and Amy Hallam (all WSP on behalf of Highways England).	Key Topics Call to review the NCC SoCG and agree next steps for how to progress it. Key Outcomes NCC Agreed to identify the relevant team members to progress the SoCG in the areas identified by the ExA in the Rule 6 Letter [PD-006].

Date	Form of Correspondence	Key Topics Discussed and Key Outcomes
21/01/21 – 01/02/21	Virtual Meeting and Email	<p>Key Topics</p> <p>Meeting to discuss agreement to transport modelling elements.</p> <p>Key Outcomes</p> <p>At the meeting the Applicant clarified the detail of flows presented in the ES, signposted NCC to the sections of the Case for the Scheme [APP-344] which detail the operational junction modelling and provided further information on the forecast model flows to enable NCC to undertake a full review.</p>
23/01/21 – 25/01/21	Emails between Andy Williams (WSP on behalf of Highways England) and Mary Fisher and (on behalf of NCC)	<p>Key Topics</p> <p>Correspondence relating to agreement on the SoCG text, and potential amendments to the mitigation strategy at Fenrother, West Moor, Causey Park Bridge.</p> <p>Key Outcomes</p> <p>The Applicant provided NCC with a copy of DMRB Vol 10 Part 0 for information relating to the Landscape and Environmental Elements within the Landscape Mitigation Masterplans/Plans</p>
27/01/2021	Meeting via Teams. In attendance were Alex Grassam (WSP), David Green (WSP), Karen Derham (NCC) and Katherine Robbie (NCC)	<p>Key Topic</p> <p>Review of the Table of Issues (Tables 3-1 and Table 3-2) within the SoCG [REP1-027], to establish the status of the issues.</p> <p>Key Outcomes</p> <p>All issues, and the status of those issues, as presented within the SoCG submitted at Deadline 3 are Agreed , although still in draft.</p>
01/02/21	<p>Meeting via Teams. In attendance were Mike Collins (Historic England), Alex Grassam (WSP), Kevin Stubbs (WSP), Natasha Powers (WSP), Lowri McCann (WSP), Mark Stoneman (Highways England), Karen Derham (NCC), Shiona MacDonald (CJP), Mike Hitchinson (CJP).</p> <p>Email from Alex Grassam (WSP) to Mike Collins (Historic England) and Karen Derham (NCC).</p>	<p>Key Topic</p> <p>Presentation of the following proposed amendments to the Scheme and assessment of the impacts on the Historic Environment:</p> <ol style="list-style-type: none"> 1. Earthwork Amendments 2. River Coquet Stabilisation Works 3. River Coquet Southern Access works. <p>Key Outcome</p> <p>A general discussion was held on potential changes to the Scheme and the potential impacts on heritage assets. The changes are the subject of an ongoing consultation exercise. This will be the subject of further discussion before Deadline 4.</p>

Date	Form of Correspondence	Key Topics Discussed and Key Outcomes
05/02/21	<p>Meeting between Highways England and Ann Deary- Francis (NCC Ecologist)</p> <p>Natural England were also in attendance.</p>	<p>Key Topic</p> <p>Highways England provided a summary of the findings of the Updated Biodiversity Air Quality DMRB Sensitivity Assessment to be issued to the ExA at Deadline 3 [REP3-010]. The updated assessment was in response to:</p> <ul style="list-style-type: none"> – The change in the opening year from 2023 to 2024 (with associated changes to traffic flows and speeds); – The release of updated air quality datasets (with associated changes in speed-banded vehicle emission rates and background concentrations); and – Reflection by the Applicant of how the updated DMRB guidance (namely LA 108 Biodiversity) has been applied to the assessment. <p>Highways England confirmed that the previous DMRB sensitivity assessment (Appendix 16.7 Biodiversity DMRB Sensitivity Test: The Scheme [APP-333]) concluded that there would be no significant effects (adverse or beneficial) to ecological receptors as a result of changes in operational nitrogen deposition.</p> <p>Highways England explained that the updated DMRB sensitivity assessment concluded that increases in nitrogen deposition may lead to significant adverse effects at the following:</p> <ul style="list-style-type: none"> – Borough Woods Local Nature Reserve (LNR) and ancient woodland (impacted area of LNR contains the impacted area for the ancient woodland) – Well Wood ancient woodland – Veteran tree T682 – Veteran tree T701 <p>Highways England confirmed that no significant effects to the River Coquet and Coquet Valley Woodlands SSSI were predicted as the Maintain air quality attribute threshold (1.7 kg N/ha/yr) is not predicted to be exceeded (maximum increase predicted to be 1.3 kg N/ha/yr).</p> <p>Highways England presented mitigation options where significant effects may occur as a result of operational nitrogen deposition. Highways England explained that LA 105 Air Quality (the updated DMRB guidance) states the following mitigation measures should be assessed for suitability, alongside any other proposed viable mitigation measures for the project:</p> <ol style="list-style-type: none"> 1. vertical barrier of at least 9m in height 2. speed limits adjusted for air quality <p>Highways England explained that preliminary discussions within the project team concluded both options to be unviable for the ecological receptors under consideration.</p> <p>Following the discussion of mitigation options, opportunity for compensation was discussed. Highways England confirmed that the following compensation opportunities had been identified and were to be explored further:</p> <ul style="list-style-type: none"> - Both veteran trees are located within grazed grassland fields (believed to be sheep). Highways England suggested the installation of stock fencing around the tree to reduce the pressures of grazing. - Highways England enquired regarding other known pressures on the Borough Woods LNR/ancient woodland and Well Wood ancient woodland, where it may be possible to develop intervention measures to “offset” the impacts of increased operational nitrogen deposition predicted as a result of the Scheme.

Date	Form of Correspondence	Key Topics Discussed and Key Outcomes
		<p>Key Outcomes</p> <p>NCC did not provide comment on the findings of the air quality assessment. With regards to the assessment for the River Coquet and Coquet Valley Woodlands SSSI, NCC confirmed that they would defer to Natural England for this matter.</p> <p>NCC stated that their Country Parks Team may be able to assist with the identification of potential mitigation and compensation opportunities with regards to the predicted impacts to Borough Woods and Well Wood. Highways England and NCC Agreed to engage further to identify potential mitigation and compensation opportunities.</p> <p>Key Topic</p> <p>NCC raised a query about the impact to the white-clawed crayfish population within the River Wansbeck as a result of predicted increases in nitrogen deposition from vehicular emissions as a result of the Scheme.</p> <p>Key Outcome</p> <p>Highways England confirmed that LA 105 Air Quality (the DMRB guidance) screens out impacts to watercourses (rivers and streams) as there is no critical load for nitrogen for this habitat and insufficient scientific information to inform an assessment. In addition, LA 105 does not require an assessment at the species level. However, Highways England confirmed it would not be expected that the Scheme would result in levels of increased nitrogen deposition that would acidify the watercourse to a level that would adversely impact the crayfish population. Highways England reviewed this matter further following the meeting and provided a response via email on 10/02/21 (see below).</p>
10/02/21	Email from Highways England to Ann Deary-Francis (NCC Ecologist)	<p>Key Topic</p> <p>Follow up email to the meeting held on 05/02/21 (see above) and the query from NCC regarding the impacts to white-clawed crayfish as a result of predicted increases in in nitrogen deposition from vehicular emissions as a result of the Scheme.</p> <p>Highways England confirmed that this matter was discussed with internal aquatic ecologists, who confirmed the following:</p> <ul style="list-style-type: none"> - White-clawed crayfish occur in areas with relatively hard, mineral-rich waters on calcareous and rapidly weathering rocks. The white-clawed crayfish is principally found in clean, alkaline waters. Most populations in the British Isles are associated with waterbodies in areas with chalk, limestone or sandstone deposits where calcium (5 mg l-1 minimum) and pH (6.5–9.0) levels are suitable. - A study by Durham University of the white-clawed crayfish distribution with the River Wansbeck indicates that the water Ca²⁺ levels range between approx. 40-60 mg/l and Mg²⁺ between 8-15 mg/l. This would give an approximate General Hardness (GH) of 174 mg/l, which would indicate hard water and therefore a high buffering capacity. The pH of the river ranges between 7.1 and 8.1. The hardness of the drinking water of the area (Morpeth) is also classed as hard (>200mg/l). The underlying geology of the area is understood to predominantly be sandstone with some limestone, which tallies with the water hardness. - This gives confidence in stating that the buffering capacity of such water, together with dilution/flushing rate, will mean that an increase in atmospheric nitrogen deposition resulting from the Scheme will not result in a pH increase of the water within the River Wansbeck. <p>Overall, Highways England confirmed the literature review provides confidence in scoping out significant adverse effects to the population of white-clawed crayfish within the River Wansbeck as a result of the predicted increase in nitrogen deposition from vehicle emissions during the operation of the Scheme.</p>

Date	Form of Correspondence	Key Topics Discussed and Key Outcomes
		Key Outcomes NCC provided agreement with the conclusions drawn in relation to the impacts to white-clawed crayfish within an email dated 16/02/21.
15/02/21	Meeting via Teams between Katherine Robbie (NCC Planning), Kevin Mavin (NCC Streetworks) and Matthew Payne (NCC Highways) with HE, CJP and WSP team.	Key Topic Discussion on the content of the Outline Construction Traffic Management Plan (OCTMP) [REP3-015 and 016]. Key Outcome It was Agreed that the OCTMP submitted at Deadline 3 had been updated in line with previous feedback from the NCC Streetworks team. Some concerns raised on the diversion route onto the A697 and volume of HGVs impacting on Longhorsley and other villages along the route. WSP confirmed that traffic flows modelled during construction do not identify a significant increase. NCC and traffic team to liaise on model. CJP Traffic Management liaison officer swapped contact details with NCC Streetworks representative.
16/02/21	Meeting via Teams between David Green (WSP, on behalf of HE) and Katherine Robbie and Matthew Payne (NCC)	Key Topic Discussion of progress of the NCC SoCG. Key Outcome It was Agreed that the SoCG submitted at Deadline 3 [REP3-017] would be updated and re-circulated to progress the document. Good progress over Heritage and Landscape was noted, albeit with some issues still outstanding.
17/02/21	Meeting via Teams between Katherine Robbie (NCC Planning) and David Brooks (NCC PRow) with Highways England and WSP team.	Key Topic Discussion on the Public Rights of Way and Access Plans [REP1-003] and dDCO [REP1-005 and 006]. Key Outcome It was Agreed that the PRow plans submitted at Deadline 1 had been updated in line with previous feedback from the NCC PRow team. NCC wanted to review the latest submission of the plans at Deadline 2 [REP2-003] and if there were any minor corrections then these would be put in writing at Deadline 4 by NCC.
01/03/21	Email from Highways England to Ann Deary-Francis (NCC Ecologist)	Key Topic Further to the meeting on the 05/02/21 (see above), Highways England requested the details of NCC's Countryside Management Team in order to progress discussions to identify opportunities for mitigation and compensation in relation to the potential for significant effects identified as a result of the air quality assessment.

Date	Form of Correspondence	Key Topics Discussed and Key Outcomes
		<p>Key Outcome</p> <p>The email was forwarded to Neil Dawson, Countryside and Green Spaces Officer, who provided a response on 01/03/21 confirming the appropriate person to approach would be Jimmy Reith, Parks and Green Spaces Team Leader, who was copied into the email. Highways England issued a follow up email on 08/03/21 (see below).</p>
02/03/21	Meeting via Teams with David Laux and Matthew Payne (NCC Highways) with HE, CJP and WSP team.	<p>Key Topic</p> <p>Concerns from NCC on the detail and extent of the highway boundary, drainage and soft estate across the scheme. Also a discussion about the nature of the Stopping Up Orders and highway ownership.</p> <p>Key Outcome</p> <p>NCC generally content with the extent of the highways to be adopted across both Parts A and B.</p> <p>The elements previously annotated in the Proposed Highway Adoption & Maintenance Responsibilities Plans [REP3-003] and the Maintenance Boundary Technical Note [REP1-049] were Agreed with NCC. The Applicant undertook to provide further clarification to NCC on elements of soft estate in Part A to be adopted, following which the plans and Technical Note for Part A will be updated and submitted at Deadline 6.</p> <p>The strategic road network currently includes the layby at West Lodge. The Applicant confirms that it is proposing a similar solution to that at Priests Bridge and will discuss this further with the NCC Officers. If an update to the Rights of Way and Access Plans [REP2-003] is required, this will be re-submitted at Deadline 6.</p> <p>A date for a follow up meeting with NCC Officers is planned for 09/04/2021.</p> <p>Part B East Linkhall Road – WSP confirmed change to 2-lane but note potential pinch-point.</p> <p>Part B West Linkhall Road – NCC request for pinch-point to be shortened and narrowed. WSP to prepare new General Arrangement (GA).</p> <p>Part B Rock South Access Road – NCC request to narrow track width. WSP to prepare new GA.</p> <p>Drainage – NCC request for all of the above to have positive drainage system and for all detention basins to be combined and under Highways England maintenance. WSP to work up amendments for Highways England to consider with Operations team and report back to NCC at next meeting w/c 15/03/21.</p>
04/03/21	Email from Matthew Payne (NCC Highways Development Manager) to Highways England	<p>Key Topic</p> <p>NCC identified some key areas that need more investigation to understand why the traffic model has shown what it is showing and then make an assessment in relation to the reassigned flows reported:</p> <ul style="list-style-type: none"> – In the Morpeth area there are peak hour traffic increases through Hebron village and going into Morpeth via the A192; – To the west of the A1 around Mitford there seems to be a re-routing of traffic accessing the A1 from the Scots Gap area moving from routes via Netherwitton staying on the B6343 to get to Mitford and then using the St Leonards Lane line to get to the A1; and – The modelling would also suggest a new route has been developed between the A697 and A1 via the route signposted from the A1 to Whittingham at the A1 junction to the south of Alnwick via the B6341 towards Whittingham at the A697.

Date	Form of Correspondence	Key Topics Discussed and Key Outcomes
		Key Outcome Highways England has supplied the requested modelling to NCC and is continuing to engage to resolve these issues at Deadline 8a.
08/03/2021	Email from Highways England to Matthew Payne (NCC Highways Development Manager)	Key Topic The Applicant provided a response and additional information relating to the three queries raised by in Matthew Payne's email of 04/03/21 (above), Key Outcome The following responses were provided: Question 1 – Flows on the A192 and through Hebron The base year model was built for the year 2015, before the Morpeth Northern Bypass was built and hence it is not included in the base year model. However, it has been included within the forecast models. The baseline traffic surveys are likely to have captured a representative sample of trips through the area, including through Morpeth. The Applicant would expect that these existing trips would make up the bulk of the trips through the Morpeth Northern Bypass once it was built, due to reassignment of these trips onto the Northern Bypass. However, it is possible that there are some trip movements through the Northern Bypass that were not captured, but Highways England would expect them to be a minor part of the total traffic. Furthermore, any such traffic would be expected to be present in both cases without and with the A1 dualling. Therefore, the reason for the decrease in Morpeth Northern Bypass traffic due to the A1 dualling is probably not linked to the baseline traffic being observed prior to the Northern Bypass being constructed. There are traffic increases due to the scheme on the A192 and on the B1337 past Hebron. The accompanying decrease in traffic on the Morpeth Northern Bypass is due to re-assignment of traffic. The increase in traffic along the adjacent junctions makes this route slightly less attractive, and some traffic can divert via Hebron onto the Highlows junction. Question 2 – Flows through St Leonards Lane The SATURN traffic model is a dynamic assignment model. The model assigns the vehicles to the optimum travel paths. The model traffic demand is based on observed traffic. For minor side roads, the observed traffic will tend to have small sample sizes, therefore it is expected that it is more difficult to forecast the flows on these routes, as the flows tend to be minor, and within the margin of error for such models. Question 3 – Traffic from south of Alnwick to A697 Analysis of the SATURN traffic model shows that the increase in traffic using the minor road between the A1 junction to Whittingham and the A697 (Lemington Bank and Garmintedge Bank) is due to traffic using Part A of the Scheme and then diverting onto the A697. Due to the dualling, this route has become more attractive, and the model has accordingly assigned this traffic to this route. Without the dualling, this traffic uses the A697.
08/03/21	Email Highways England to Jimmy Reith (NCC Parks and Green Spaces Team Leader)	Key Topic Further to an email on 01/03/21 (see above), Highways England requested a meeting to discuss opportunities for mitigation and compensation at Borough Woods LNR/ancient woodland and Well Wood ancient woodland in relation to significant effects identified as a result of air quality.

Date	Form of Correspondence	Key Topics Discussed and Key Outcomes																												
		Key Outcome Highways England received no response and issued follow up emails on 23/03/21, 06/04/21, 22/04/21 and 05/05/21 to request a response. A response via phone call was received on 06/05/21 (see below).																												
09/03/21	Skype call between David Green (WSP, on behalf of the Applicant) and Katherine Robbie (NCC Case Officer).	Key Topic Discussion on the progress of the SoCG. Key Outcome A number of areas of common ground were Agreed as set out in Table 3-2, below.																												
24/03/21	Emails between the Applicant and Matthew Payne (NCC Highways Development Manager)	Key Topic The Applicant brought it to the attention of NCC that there was an error in their Table 36.2 in the Applicant’s Response to Deadline 4 submission [REP5-029], whereby the information in Table 36.1 had been duplicated in error. Key Outcome Mr Payne provided a corrected version of Table 36.2 at Deadline 5. <i>Table 36.2 – Forecast Traffic Flows on De-Trunked A1 within Part A (Source: Traffic flows from SATURN model of scheme as supplied by WSP direct to NCC)</i> <table><tr><th>Section</th><th>AM Peak (2-way)</th><th>PM Peak (2-way)</th><th>Annual Average Daily Traffic (AADT)*</th></tr><tr><td>South of Fenrother</td><td></td><td></td><td>152</td></tr><tr><td>Fenrother to Earsdon</td><td>192</td><td>213</td><td>2,525</td></tr><tr><td>Earsdon to Causey Park</td><td>168</td><td>201</td><td>2,436</td></tr><tr><td>Causey Park to Eshott</td><td>50</td><td>75</td><td>1,241</td></tr><tr><td>Eshott to Burgham Park</td><td>21</td><td>42</td><td>547</td></tr><tr><td>Burgham Park to West Moor</td><td>31</td><td>58</td><td>723</td></tr></table>	Section	AM Peak (2-way)	PM Peak (2-way)	Annual Average Daily Traffic (AADT)*	South of Fenrother			152	Fenrother to Earsdon	192	213	2,525	Earsdon to Causey Park	168	201	2,436	Causey Park to Eshott	50	75	1,241	Eshott to Burgham Park	21	42	547	Burgham Park to West Moor	31	58	723
Section	AM Peak (2-way)	PM Peak (2-way)	Annual Average Daily Traffic (AADT)*																											
South of Fenrother			152																											
Fenrother to Earsdon	192	213	2,525																											
Earsdon to Causey Park	168	201	2,436																											
Causey Park to Eshott	50	75	1,241																											
Eshott to Burgham Park	21	42	547																											
Burgham Park to West Moor	31	58	723																											
13/04/21	Meeting between Sophie Collins (on behalf of the Applicant) and NCC.	Key Topic Discussion between the Applicant and NCC in relation to the impacts of the Scheme on Population and Human Health.																												

Date	Form of Correspondence	Key Topics Discussed and Key Outcomes
		Key Outcome It was Agreed that the impacts of the Scheme on Population and Human Health have been fully assessed. A summary of impacts on communities within the Population and Human Health study area (1km from the Scheme) was requested by NCC, and the Applicant undertook to provide this.
19/04/21	Skype call between Andrew Williams and David Green (WSP, on behalf of the Applicant) and Katherine Robbie (NCC Case Officer) and Mark Evans (on behalf of NCC).	Key Topic Discussion on landscape impacts of the Scheme. Key Outcome Further of areas of common ground Agreed , and recorded in Table 3-2, below.
27/04/21	Skype call between David Green (WSP, on behalf of the Applicant) and Katherine Robbie (NCC Case Officer).	Key Topic Discussion on the progress of the SoCG. Key Outcome A number of areas of common ground were Agreed and further areas of the SoCG Agreed , as set out in Table 3-2, below.
28/04/21	Exchange of emails between Nicola Bolton (WSP, on behalf of the Applicant) and Gary Park (NCC Environmental Protection Officer)	Key Topic Confirmation of some final aspects of the SoCG in relation to noise. Key Outcome Final matters in relation to noise Agreed , and the SoCG Agreed as set out in Table 3-2, below.
04/05/21	Email exchange between Katherine Robbie (Senior Planning Officer, NCC) and David Green (WSP on behalf of Highways England).	Key Topic Discussion over the level of detail required to help NCC understand the philosophy and timings of the proposed Landscape Mitigation Management Plan that is required. Key Outcome Agreed that a further narrative for the Outline CEMP is required, but that an Outline Landscape and Ecological Management Plan (LEMP) is not required at this stage of the DCO.
06/05/21	Phone call from Neil Dawson (NCC Countryside and Green Spaces Officer) to Highways England	Key Topic Further to emails between 01/03/21 and 05/05/21 (see narrative in entry on 08/03/21, above), Highways England received a phone call from NCC regarding opportunities for mitigation and compensation at Borough Woods LNR/ancient woodland and Well Wood ancient woodland in relation to significant effects identified as a result of air quality.

Date	Form of Correspondence	Key Topics Discussed and Key Outcomes
		<p>NCC confirmed that this matter would be discussed with the relevant officers for Borough Woods and Plessey Wood (connected to Well Wood) to identify areas of possible compensatory planting and/or other enhancement measures (to address existing threats and pressures to the sites).</p> <p>Key Outcome</p> <p>NCC confirmed that a response would be provided by 10/05/21. Highways England provided a follow up email on 06/05/21 (see below) confirming the information requested.</p>
06/05/21	Email from Highways England to Neil Dawson (NCC Countryside and Green Spaces Officer)	<p>Key Topic</p> <p>Further to the phone call earlier in the day (06/05/21, see above), Highways England confirmed that an air quality assessment had been completed for the Scheme that identified increases in nitrogen that may give rise to significant effects in relation to the Borough Woods LNR and ancient woodland and Well Wood ancient woodland (Plessey Wood).</p> <p>Highways England confirmed that they are exploring opportunities for:</p> <ul style="list-style-type: none"> - Compensation for the theoretical damage of habitat through provision of equivalent habitat. The area impacted is adjacent to the A1 carriageway and therefore preference would be given to planting adjacent to the impacted area but outside the area of additional nitrogen deposition (i.e. outside 20m from the A1). From the phone conversation on 06/05/21, Highways England confirmed that they were made aware that Plessey Wood (managed by NCC) is located approximately 2.5km to the east of the A1 and potentially impacted area. However, given that Plessey Wood is contiguous with the potentially impacted area of Well Wood ancient woodland, opportunities at Plessey Wood remain a consideration. The area potentially impacted at both sites by increased nitrogen deposition is approximately 0.1ha and therefore the Highways England would be seeking compensation planting of at least the same size. - Enhancement, through the provision of measures to address existing threats and pressures to the sites, to support an improvement in the overall conservation status. For this, Highways England requested any information regarding current threats and pressures that may offer an opportunity for enhancement. <p>Key Outcome</p> <p>Highways England received a response via email on 11/05/21 (see below from Danny Goodall, NCC Country Park & Sites Officer).</p>
06/05/2021	Phone call from Highways England to Ann Deary-Francis (NCC Ecologist)	<p>Key Topic</p> <p>Further to Issue Specific Hearing 3 (ISH3), where NCC stated that they would usually assume otter as present in Northumberland, discussion regarding the assessment of otter and requirement for mitigation.</p> <p>Key Outcome</p> <p>Highways England confirmed they were not aware of NCC's position regarding otter presence in Northumberland. Highways England confirmed that, following ISH3, Highways England held discussions with the Environment Agency on 23 and 30 April 2021 to explore the evidence for the presence of otter. Further possible evidence was provided by the Environment Agency at the meeting on 30 April (spraint along Shipperton Burn), and Highways England is in the process of considering this and the potential need for fencing along Part B at four key crossing locations.</p>

Date	Form of Correspondence	Key Topics Discussed and Key Outcomes
		<p>NCC welcomed the exploration of mitigation for otter passage. Highways England confirmed they would continue to engage with NCC on this matter and also keep NCC informed of progress of discussions with the Environment Agency.</p>
07/05/21	Email from Highways England to Ann Deary-Francis (NCC Ecologist)	<p>Key Topic</p> <p>Discussion regarding NCC's post-hearing note issued at Deadline 6 [REP6-050] and the statement regarding water vole for Part B. NCC noted that some evidence of water vole was identified in early surveys undertaken by Highways England [APP-300] and that water vole are under-reported in recently years and considered rare in the county. NCC stated that where pre-construction updating surveys confirm presence suitable mitigation will be required. NCC stated it is acceptable for this to be included as a Requirement.</p> <p>Highways England provided a summary of their intended response, as follows:</p> <ul style="list-style-type: none"> - A water vole survey undertaken in 2016 by the Applicant purported to have recorded potential water vole field signs along Part B. However, the field signs recorded were not conclusively attributed to water vole and field signs of mink were also recorded, indicating presence and activity of this species in the area. Presence of mink is a significant factor reducing the likelihood of water vole occurring. It is generally accepted that mink can eradicate a water vole population if present. - Updated field surveys were undertaken in 2018 and 2019 and no evidence of water vole activity or presence was recorded. As detailed in Table 9-9 of Chapter 9: Biodiversity Part B [APP-049], water vole is considered likely absent from within Part B and Part B Survey Area. - Requirement 7, Schedule 2 of the Draft DCO [REP5-034 and 035] states that "following pre-construction survey work or at any time when carrying out the authorised development, a) a protected species is shown to be present, or where there is a reasonable likelihood of it being present ... the relevant parts of the relevant works must cease until a scheme of protection and mitigation measures has been submitted to and approved in writing by the Secretary of State." <p>Highways England requested NCC to confirm if they agree with the response presented and if they are satisfied that the Requirement within the Draft DCO is sufficient with regards to water vole.</p> <p>This matter is also captured in Item 7.10 of Table 3-2 below.</p> <p>Key Outcome</p> <p>NCC's Ecologist confirmed via an email reply on 07/05/21 "<i>that seems very reasonable.</i>" NCC's Ecologist later confirmed within a phone call on 18/05/21 (see below) that this matter is Agreed</p>
11/05/21	Email from Danny Goodall (NCC Country Park & Sites Officer) to Highways England	<p>Key Topic</p> <p>Opportunities for mitigation and/or compensation in relation to increases in nitrogen that may give rise to significant effects in relation to the Borough Woods LNR and ancient woodland and Well Wood ancient woodland (Plessey Wood). Further to the phone call and subsequent email from Highways England on 06/05/21 (see above), NCC provided suggested options for woodland management and improvements through native species planting at both sites. NCC consider that the options would enhance and future proof existing woodland.</p>

Date	Form of Correspondence	Key Topics Discussed and Key Outcomes
		Key Outcome Highways England provided a response via email on 24/05/21 (see below).
14/05/21	Email from Matthew Payne (NCC Highways Development Management) to Highways England	Key Topic NCC has three remaining areas of concern reported in the peak hour modelling: <ul style="list-style-type: none"> – Additional trips through Hebron village - model showing people using this route over the Morpeth By-Pass from Pegswood; – Additional trips on St Leonards Lane from Mitford; and – Routing from A697 to A1 going cross country from Whittingham to existing A1 dual at Shilbottle. NCC is of the opinion that these re-routings are more because of the modelling methodology and assumptions rather than the route choice of regular commuters. On that basis they request that these routes are included in the post-scheme monitoring and then if the traffic flows are in line with the model, appropriate action can be taken at that time. Key Outcome Highways England agrees that the forecast flows may well not materialise in reality, given that there are alternative more logical routes that drivers will probably use. Highways England will continue to engage with NCC on this matter.
17/05/21	Email from Highways England to Ann Deary-Francis (NCC Ecologist)	Key Topic NCC's post-hearing note issued at Deadline 6 [REP6-050] and the statement regarding water vole for Part B (further to Highways England's email dated 07/08/21 (see above). Highways England requested confirmation that this matter, captured as Item 7.10 of Table 3-2 below, could be identified as "Agreed". Key Outcome NCC's Ecologist provided a response during a phone call on 18/05/21 (see below).
17/05/21	Meeting between NCC and the Applicant's Operation Team	Key Topic Meeting to discuss the de-trunked handover condition of the asset. Key Outcome A meeting with the Applicant's operations team Agreed that existing records are to be shared with NCC. These are to cover pavement, drainage, culvert and footway condition surveys. Further liaison meetings to study survey results and agree what an appropriate standard for handover would look like. Amendment to the dDCO vesting statement to be Agreed for Deadline 8, covering this aspect.
18/05/21	Email from Highways England to Ann Deary-Francis (NCC Ecologist)	Key Topic In response to BIO.3.1 of the ExA written questions 3, which relates to the position regarding the otter assessment and potential mitigation, Highways England suggested that a joint response is provided from Highways England (the Applicant), NCC and the Environment Agency. Highways England also provided a bullet list to outline the intended response and requested comment from NCC, which would:

Date	Form of Correspondence	Key Topics Discussed and Key Outcomes
		<ul style="list-style-type: none"> - Confirm NCC agree with the impact assessment and mitigation for otter for Part A - Confirm it is Part B exclusively that NCC disagree with the conclusion of the otter assessment (i.e. disagree that otter is likely absent) and have requested mitigation. - Confirm the Environment Agency provided recent evidence of otter on Shipperton Burn and that the Applicant has re-evaluated the position and accept otter are present within the Order limits of Part B. - Confirm the Applicant has proposed otter fencing at four locations and that NCC are in agreement with this mitigation. <p>Key Outcome NCC provided a response via email on 18/05/21 (see below) and the matter was also briefly discussed during a phone call on 18/05/21 (see below).</p>
18/05/21	Email from Ann Deary-Francis (NCC Ecologist) to Highways England	<p>Key Topic In response to Highways England's email dated 18/05/21 (see above), NCC Agreed with the approach to providing a joint response along with the Environment Agency and Highways England to BIO.3.1 of the ExA written questions 3.</p> <p>Key Outcome The matter was briefly discussed during a subsequent phone call on the 18/05/21 (see below), following a separate call between Highways England and the Environment Agency.</p>
18/05/21	Phone call from Highways England to Ann Deary-Francis (NCC Ecologist)	<p>Key Topic NCC's post-hearing note issued at Deadline 6 [REP6-050] and the statement regarding water vole for Part B (further to Highways England's email dated 07/08/21 (see above). Highways England requested confirmation that this matter, captured as Item 7.10 of Table 3-2 below, could be identified as "Agreed".</p> <p>Highways England also confirmed that they had discussed the approach to the response to BIO.3.1 of the ExA written questions 3 (see emails from 18/05/21 above) with the Environment Agency, who also Agreed with the approach to a joint response.</p> <p>Key Outcome NCC's Ecologist confirmed that Item 7.10 of Table 3-2 could be marked as "Agreed".</p> <p>Highways England confirmed that they would draft a response to BIO.3.1 and circulate to NCC and the Environment Agency for comment prior to submission at Deadline 8 (25 May 2021).</p>
19/05/21	Phone call from Highways England to Ann Deary-Francis (NCC Ecologist)	<p>Key Topic Highways England requested comment from NCC regarding the proposed removal of B-B30 (post-construction otter monitoring for Part B, followed by retrospective mitigation) from the Outline CEMP given that this is now redundant (as otter fencing is now proposed upfront).</p> <p>Key Outcome NCC's Ecologist Agreed that the removal of B-B30 from the Outline CEMP was appropriate.</p>

Date	Form of Correspondence	Key Topics Discussed and Key Outcomes
19/05/21	Meeting with NCC and the Applicant	<p>Key Topic Follow up meeting to discuss the de-trunked handover condition of the asset, provision of NMU on the de-trunked length and its overall north-south connectivity and the methodology for determining ownership and maintenance of the local roads. Also, to discuss the extent of the adoption of East Linkhall Road, speed limits on the three new access roads (West / East Linkhall and Rock South Access Roads) and drainage options on Rock South Farm Access Road.</p> <p>Key outcome NCC's position on NMU on the de-trunked length has not changed and NCC have provided outline plan of full north-south connectivity strategy. NCC will provide suggested changes to the dDCO to provide the full NMU opportunities for the ExA at Deadline 8. This has been shared with the Applicant for comment and is currently under review. However, the Applicant confirmed that opportunities for further NMU could only be funded outside the DCO. Designated Funds workshops are being held separately to advance this. The position is recorded at 12.3 of Table 3.2, below.</p> <p>A draft methodology of determining adoption and maintenance liability, and to act as a record of what has been Agreed at this stage, was shared prior to the meeting. Additional measures are Agreed to be added and a follow up meeting requested by NCC to work through the document in time for Deadline 8a.</p> <p>NCC will adopt the new East Linkhall Road up to tie in with existing track. Agreed that new turning head is to be included in future GA plans [REP6-005]. Land ownership to be clarified to existing owners to avoid future queries to NCC.</p> <p>Applicant Agreed to amend speed limit in dDCO Schedules [REP6-010 and 011] to match the Traffic Regulations Measures Plan [REP6-007] which NCC have previously Agreed</p> <p>NCC has stated that it is not prepared to adopt Rock South Farm Access Road with the current drainage proposal. Agreed that the ultimate outcome is still for NCC adoption and two options to be progressed:</p> <ol style="list-style-type: none"> Improvements to address low spots within Order limits but increase standard 1yr maintenance liability to 2/3yrs to monitor new drainage performance; Agree with Rock Estate to undertake, by Agreement, enhanced drainage provision outside the Order limits. Further meeting to be held with NCC to discuss drainage options in detail.
20/05/21	Email from Highways England to Ann Deary-Francis (NCC Ecologist)	<p>Key Topic Further to emails on 18/05/21 (see above), Highways England issued draft text for the joint response to BIO.3.1 and the proposed Part B otter fencing measure for the Outline CEMP to NCC for comment.</p> <p>Key Outcome NCC provided a response on 24/05/2021 (see below).</p>
24/05/2021	Email from Ann Deary-Francis (NCC Ecologist) to Highways England	<p>Key Topic Wording of the joint response BIO.3.1 and the proposed Part B otter fencing measure for the Outline CEMP.</p>

Date	Form of Correspondence	Key Topics Discussed and Key Outcomes
		<p>Key Outcome NCC confirmed agreement with the wording of the joint response to BIO.3.1, which was issued by Highways England at Deadline 8. NCC also Agreed with the wording of the proposed Part B otter fencing measure for the Outline CEMP; measure ExA: B-B100 of the Outline CEMP issued at Deadline 8.</p> <p>The Applicant has Agreed with NCC that the proposed mitigation is sufficient to address their concerns regarding otter for Part B. As such, the assessment of, and proposed mitigation for, otter is Agreed for the Scheme.</p>
24/05/21	Email from Highways England to NCC	<p>Key Topic Opportunities for compensation in relation to increases in nitrogen that may give rise to significant effects in relation to the Borough Woods LNR and ancient woodland and Well Wood ancient woodland (Plessey Wood). Further to NCC's email dated 11/05/21 (see above), Highways England confirmed that they consider the proposed habitat improvement measures to be viable to be explored further.</p> <p>Highways England requested details of the proposed compensation measures from NCC.</p> <p>Key Outcome NCC provided an initial response on 26/05/21 (see below).</p>
26/05/2021	Emails from NCC to Highways England	<p>Key Topic Compensation for air quality impacts. NCC confirmed that an internal meeting had been held on 25/05/21 and that information was being prepared to respond to Highways England's email dated 24/05/21 (see above).</p> <p>NCC requested confirmation that what was needed was a <i>"fair approximate cost and spec for the works and agreement/commitment to delivery at this stage"</i>.</p> <p>Key Outcome Highways England responded on 26/05/21 to confirm that they request a cost (commuted sum) and a description of what works this covers and when this would be delivered (with reference to financial years). Highways England confirmed this would be packaged within a legal agreement that would be drawn up for agreement. NCC provided a cost via email on 02/06/2021 (see below).</p>
27/05/2021	Email from Highways England to Matthew Payne (NCC Highways Development Manager)	<p>Key Topic With reference to the email received from Matthew Payne on 14/05/2021, Highways England agree with NCC that the flows forecast by the traffic model in the three locations may well not materialise in reality, given that there are alternative more logical routes that drivers will probably use. Highways England have undertaken another review of the forecast flows in these locations and note that the increases are relatively low – in the region of 1-2 additional vehicles per minute on the two-way flow as shown in the table below.</p>

Date	Form of Correspondence	Key Topics Discussed and Key Outcomes																																								
		<table><tr><td></td><td></td><td colspan="6">Vehicles</td></tr><tr><td></td><td></td><td>DM AM</td><td>DM PM</td><td>M2E AM</td><td>M2E PM</td><td>increase AM</td><td>increase PM</td></tr><tr><td>2 way</td><td>Flows past Hebron</td><td>164</td><td>182</td><td>276</td><td>314</td><td>112</td><td>132</td></tr><tr><td>2 way</td><td>Flows on St Leonards Lane</td><td>294</td><td>368</td><td>398</td><td>429</td><td>104</td><td>60</td></tr><tr><td>2 way</td><td>Flows from A697 to A1</td><td>154</td><td>140</td><td>266</td><td>240</td><td>111</td><td>100</td></tr></table> <p>Key Outcome</p> <p>Given that the increases are relatively low, as are the do minimum flows, Highways England do not consider they are sufficient to warrant concern or justify the need for post Scheme opening monitoring. Highways England will continue to engage with NCC on this matter.</p>			Vehicles								DM AM	DM PM	M2E AM	M2E PM	increase AM	increase PM	2 way	Flows past Hebron	164	182	276	314	112	132	2 way	Flows on St Leonards Lane	294	368	398	429	104	60	2 way	Flows from A697 to A1	154	140	266	240	111	100
		Vehicles																																								
		DM AM	DM PM	M2E AM	M2E PM	increase AM	increase PM																																			
2 way	Flows past Hebron	164	182	276	314	112	132																																			
2 way	Flows on St Leonards Lane	294	368	398	429	104	60																																			
2 way	Flows from A697 to A1	154	140	266	240	111	100																																			
27/05/2021	Email from Matthew Payne (NCC Highways Development Management) to the Applicant	<p>Key Topic</p> <p>With reference to the email from the Applicant on 27/05/2021, NCC agrees that the flows in the three locations are low, but if one considers percentage increases there are some significant changes to these routes, if the modelling is correct. Whilst the network is likely to accommodate the extra traffic in pure capacity terms, there could be an increased number of potential additional conflicts on the single track section of St Leonard's Lane and the various junctions on the cross A697-A1 route that includes a crossroads junction with a B-class road.</p> <p>On that basis, it would remain NCC’s position that these links be included in the post-scheme monitoring.</p> <p>Key Outcome</p> <p>Highways England will agree to post-construction monitoring and will continue to engage with NCC on this matter. Final agreement to be captured in the next iteration of the outline Construction Traffic Management Plan [REP8-013 and 014].</p>																																								
28/05/2021	Regular monthly liaison meeting between NCC and the Applicant	<p>Key Topic</p> <p>Liaison call covered the latest positions on all aspects affecting NCC across the Scheme (from traffic figures to construction phases). Discussions also covered de-trunked handover condition of the asset, the methodology for determining ownership and maintenance of the local roads, the extent of the adoption of East Linkhall Road and an update on the drainage options on Rock South Farm Access Road.</p> <p>Key Outcome</p> <p>Extent and turning head for East Linkhall Access Road Agreed by NCC. Only final action here is to inform local landowners of proposed landownership at West Lodge post-construction.</p> <p>The previously circulated Maintenance Methodology MoU was Agreed with NCC requesting two minor amendments to the text.</p> <p>Condition information on the de-trunked length still to be shared with NCC. Further meeting expected, date to be Agreed</p> <p>Drainage discussions taking place with Rock Estates and the Applicant’s contractor. Further meeting with NCC’s drainage team to be held w/c/7/6/21.</p>																																								

Date	Form of Correspondence	Key Topics Discussed and Key Outcomes
02/06/2021	Email from Leon Savage (NCC Trees and Woodlands Team Leader) to Highways England	<p>Key Topic</p> <p>Compensation for air quality impacts. Further to emails on 26/05/2021 (see above) NCC provided a cost for the proposed habitat improvements works as compensation in relation to increases in nitrogen that may give rise to significant effects in relation to the Borough Woods LNR and ancient woodland and Well Wood ancient woodland.</p> <p>Key Outcome</p> <p>Highways England are considering the cost provided and provided initial queries via email on 03/06/2021 (see below).</p>
03/06/2021	Email from Highways England to Leon Savage (NCC Trees and Woodlands Team Leader)	<p>Key Topic</p> <p>Queries regarding the proposed cost for habitat improvements associated with air quality impacts (following NCC's email dated 02/06/2021 (see above)).</p> <p>Key Outcome</p> <p>Highways England issued a draft legal agreement to secure the proposed compensation woodland management funding on 09/06/2021 (see below) for comment. Highways England subsequently received a response from NCC to the queries regarding the proposed costs on 17/06/2021 (see below).</p>
08/06/21	Meeting between Katherine Robbie (NCC) and David Green (WSP on behalf of the Applicant)	<p>Key Topic</p> <p>Discussion over progress of the Statement of Common Ground.</p> <p>Key Outcome</p> <p>Both NCC and the Applicant maintain their differing positions over NCC's proposed amendments to Schedules 1 and 3. This wording would amend the Draft DCO to require enhanced cycle and public rights of way provision as part of the Scheme. The amendments proposed by NCC are set out in their Deadline 8 submission [REP8-028b].</p> <p>Katherine Robbie confirmed that other than this issue and the wording of Requirement 17 NCC is generally satisfied with the wording of the draft DCO [REP8-005]. The Applicant has undertaken to review the wording of Requirement 17 and update the DCO at Deadline 10, and the issue is captured in Table 3-1, below.</p>
08/06/21	Email exchange between Rob Sharpe (WSP on behalf of the Applicant) and David Laux (NCC, Head of Technical Services).	<p>Key Topic</p> <p>Exchange of email over drainage arrangements for Rock South Farm Road.</p> <p>Key Outcome</p> <p>David Laux undertook to review the proposal and revert back to the Applicant with some comments. This issue is captured as Item 8.5 in Table 3.2, below.</p>

Date	Form of Correspondence	Key Topics Discussed and Key Outcomes
09/06/21	Email from Highways England to Katherine Robbie (NCC)	<p>Key Topic</p> <p>Further to previous emails (24/05/21, 26/05/21, 02/06/21 and 03/06/21), Highways England issued a draft legal agreement for the habitat improvement works as compensation for air quality impacts to Borough Woods LNR/ancient woodland and Well Wood ancient woodland as a result of the Scheme. Highways England requested comment.</p> <p>Key Outcome</p> <p>NCC requested a copy of the plans referred to in Appendix B on 15/06/2021 (see below). During a call on 25/06/21 (see below) the level of compensation was Agreed The terms of the legal agreement are agreed and it will be completed in the week beginning 05/07/2021.</p>
10/06/21	Email exchange between David Laux (NCC, Head of Technical Services) and Rob Sharpe (WSP on behalf of the Applicant).	<p>Key Topic</p> <p>Exchange of email over drainage arrangements for Rock South Farm Road.</p> <p>Key Outcome</p> <p>David Laux confirmed that there was considerable improvement in the drainage proposals from previous discussions and that in general, NCC would be content with the proposal for the northern section of the access road drainage. For the southern section, it was appreciated that there were difficulties providing a positive drainage outfall to a watercourse. NCC advised that any agreement for the proposed infiltration system would be subject to site surveys, detailed design and a prolonged period of operation after construction to prove effectiveness before local authority acceptance. Further discussions are required to agree the maintenance arrangements for this section.</p>
11/06/21	Meeting between Katherine Robbie (NCC) and David Green (WSP on behalf of the Applicant)	<p>Key Topic</p> <p>Discussion over progress of the Statement of Common Ground.</p> <p>Key Outcome</p> <p>Agreed the status of the majority of the draft DCO [REP8-005] requirements and schedules are now "Agreed " with the exception of Requirement 17 and with the exception of the wording of Schedules 1 and 3 of the draft DCO. The Applicant is reviewing the wording of Requirement 17 and any revised wording will be provided at Deadline 10 NCC set out their alternative wording for Schedules 1 and 3 in their Deadline 8 submission [REP8-028b]. The Applicant maintains that the requested changes are not required as mitigation for the impacts of the Scheme and that some of the changes sought are not deliverable within the Order Limits of the Scheme.</p> <p>This is not a matter on which it is consider likely that an agreement will be reached, so it is for the Examining Authority to make a recommendation on this matter.</p>

Date	Form of Correspondence	Key Topics Discussed and Key Outcomes
15/06/21	Email from Katherine Robbie (NCC) to Highways England	<p>Key Topic</p> <p>In response to the draft legal agreement for habitat improvement works as compensation for air quality impacts, as issued by Highways England on 09/06/2021 (see above), NCC requested a copy of the plans referred to in Appendix B. NCC also confirmed that further comments would be provided following review by their legal team.</p> <p>Key Outcome</p> <p>Highways England provided a response on 15/06/2021 (see below).</p>
15/06/21	Email from Highways England to Katherine Robbie (NCC)	<p>Key Topic</p> <p>Following NCC's email dated 15/06/2021 (see above), Highways England provided indicative plans referenced in Appendix B of the draft legal agreement for NCC's comment.</p> <p>Highways England also confirmed that several references to offsite mitigation within the draft legal agreement are intended to be amended to offsite compensation (error in terminology).</p> <p>Key Outcome</p> <p>During a call on 25/06/21 (see below) the level of compensation was Agreed , as was the approach to securing the compensation through a legal agreement. NCC returned initial comments on the draft on 25/06/2021 and it was returned to them again on 28/06/ 2021. The legal agreement is now in agreed form and will be completed in the week of 5/7/2021</p>
17/06/21	Email from Katherine Robbie (NCC) to Highways England	<p>Key Topic</p> <p>NCC provided responses to Highways England's queries regarding the proposed cost for habitat improvements associated with air quality impacts (email dated 03/06/2021, see above). NCC also provided a revised cost for Highways England's review and comment.</p> <p>Key Outcome</p> <p>The legal agreement is now in agreed form and will be completed in the week of 5/7/2021</p>
18/06/21	Email from Highways England to Katherine Robbie (NCC) and Ann Deary-Francis (NCC Ecologist)	<p>Key Topic</p> <p>Request for comment on the proposed wording for Item 7.11 of Table 3-2 of the statement of common ground, to capture NCC's position with regards the Updated Biodiversity Air Quality DMRB Sensitivity Assessment [REP3-010].</p> <p>Key Outcome</p> <p>NCC confirmed agreement with the proposed wording via email on 21/06/2021 (see below).</p>

Date	Form of Correspondence	Key Topics Discussed and Key Outcomes
21/06/21	Email from Ann Deary-Francis (NCC Ecologist) to Highways England	<p>Key Topic</p> <p>NCC confirmed agreement with the proposed wording of Item 7.11 of Table 3-2 of this SoCG, as issued by Highways England on 18/06/21 (see above).</p> <p>Key Outcome</p> <p>The SoCG was updated with the Agreed wording for issue at Deadline 10.</p>
25/06/21	Phone call between Highways England) and Katherine Robbie (NCC)	<p>Key Topic</p> <p>The draft legal agreement for habitat improvement works as compensation for air quality impacts, as issued by Highways England on 09/06/2021 (see above).</p> <p>Key Outcome</p> <p>NCC confirmed that the level of compensation is Agreed , as is the approach to securing the compensation through a legal agreement. NCC confirmed they would provide full comment on the draft legal agreement in due course. The legal agreement is now in agreed form and will be completed in the week of 5/7/2021</p>
25/06/21	Phone call between David Green and Jack Fenwick (on behalf of Highways England) and Katherine Robbie (NCC)	<p>Key Topic</p> <p>Review of the SoCG at Deadline 10.</p> <p>Key Outcome</p> <p>Some further agreements reached on matters of common ground, and a discussion over the wording of Requirement 17 (identified as Item 20 in Table 2-1, below).</p>
25/06/2021	Regular monthly liaison meeting between NCC and the Applicant	<p>Key Topic</p> <p>Liaison call covered the latest positions on all aspects affecting NCC across the Scheme (from site surveys, Deadline 9 responses to stakeholder engagement plans). Discussions also covered traffic monitoring, de-trunked handover condition of the asset, the draft DCO and this SoCG, NMU connections to Morpeth, the ownership north of the adopted East Linkhall Road and an update on the drainage options on Rock South Farm Access Road.</p> <p>Key Outcome</p> <p>Applicant has confirmed with local landowners and HMLR on the current Land Plans and BoR position at West Lodge. The Applicant intends to permanently acquire the length of track in question. It was Agreed for any change to the length of NCC adoption after construction would require the turning head to be repositioned and the asset condition brought up to an acceptable standard.</p> <p>Final batch of existing condition information, from HE Operations team, on the de-trunked length still to be shared with NCC before their gap analysis can be undertaken. However, agreement that any required interventions will be carried out by the Applicant before final handover.</p>

Date	Form of Correspondence	Key Topics Discussed and Key Outcomes
		<p>NCC restated their safety concerns on the width of the de-trunked section at handover as it could encourage higher speeds and the missed opportunity of NMU provision. The Applicant confirmed that this was an area of disagreement which should be recorded in this SoCG.</p> <p>Confirmed that all parties have Agreed to the proposed drainage options at Rock South Access Road. Principles will be captured in a revision to the previously Agreed Maintenance Methodology MoU.</p> <p>The NCC legal review of the new road naming convention in the dDCO was Agreed by both parties to be captured in the Maintenance Methodology MoU instead.</p> <p>The revised Maintenance Methodology MoU, once reviewed, would then be issued to NCC under formal letter from the Applicant.</p> <p>Output from the traffic model, reviewed by NCC, identified three areas on the local network of potentially problematic flows. Both parties agree this is most likely just an anomaly in the modelling. The Applicant has Agreed to undertake pre-construction and post-opening monitoring in line with DfT guidance. A limited commuted sum to mitigate local traffic issues would be Agreed if the monitoring does match the model. This will be secured in the oCEMP at Deadline 10.</p>
25/06/2021	e mail from NCC Legal Services to DLA Piper	<p>Key Topic</p> <p>The draft legal agreement was returned with initial comments and subject to further comment from the client department.</p> <p>Key Outcome</p> <p>A further revised agreement was returned by DLA Piper to NCC Legal Services on 28/06/2021. The legal agreement is now in agreed form and will be completed in the week of 5/7/2021</p>
28/06/2021	e mail from DLA Piper to NCC Legal Services	<p>Key Topic</p> <p>A further revised version of the agreement was returned to address the comments raised on 25/06/2021.</p> <p>Key Outcome</p> <p>The legal agreement is now in agreed form and will be completed in the week of 5/7/2021</p>
29/06/2021	e mail from NCC Legal Services to DLA Piper	<p>Key Topic</p> <p>Comments provided on draft at legal agreement.</p> <p>Key Outcome</p> <p>The legal agreement is now in agreed form and will be completed in the week of 5/7/2021</p>
29/06/2021	e mail from DLA Piper to NCC Legal Services	<p>Key Topic</p> <p>Responses provided on comments on draft at legal agreement.</p>

Date	Form of Correspondence	Key Topics Discussed and Key Outcomes
		Key Outcome The legal agreement is now in agreed form and will be completed in the week of 5/7/2021
01/07/2021	e mail from NCC Legal Services to DLA Piper	Key Topic Revised draft of legal agreement provided Key Outcome The legal agreement is now in agreed form and will be completed in the week of 5/7/2021
01/07/2021	e mail from DLA Piper to NCC Legal Services	Key Topic Confirmed that the latest changes are approved and seeking confirmation that matters now agreed. Key Outcome The legal agreement is now in agreed form and will be completed in the week of 5/7/2021
01/07/2021	e mail from NCC Legal Services to DLA Piper	Key Topic Confirmed that legal agreement now agreed. Key Outcome The legal agreement is now in agreed form and will be completed in the week of 5/7/2021
02/07/2021	e mail from NCC Legal Services to DLA Piper	Key Topic Confirming arrangements for completion of legal agreement in week of 05/07/2021. Key Outcome The legal agreement is now in agreed form and will be completed in the week of 5/7/2021
02/07/2021	Phone call; between David Green (WSP on behalf of the Applicant) and Matthew Payne and Katherine Robbie (NCC)	Key Topic Further review of the updated SoCG. Key Outcome The SoCG was discussed and the status of further issues confirmed as “agreed” or “not “agreed”. It was agreed that Item 10.2 in Table 3-2, below, could be resolved with further discussions, but that at the point that the examination closes the issue is “not agreed”.

Table 2-2 - Record of Engagement in Relation to Part A

Date	Form of Correspondence	Key Topics Discussed and Key Outcomes
26/09/16	Meeting between NCC and Highways England.	Key Topic and Outcome De-trunking of A1 from Priests Bridge to Bockenfield, including need to consider condition of asset for handover and potential changes to cross section. Highways England to provide information from previous de-trunking schemes.
31/10/16	Meeting between NCC and Highways England.	Key Topic and Outcome Traffic Modelling reviewed. De-trunking principles discussed.
10/03/17	Meeting between NCC and Highways England.	Key Topic and Outcome De-trunking principles discussed. Asset condition surveys and information required by NCC relating to existing carriageway, drainage and structures confirmed
18/05/17	Meeting between NCC and Highways England.	Key Topic and Outcome Further discussion on de-trunking principles and data required. Discussion on DCO process and roads which may be for adoption by NCC
28/07/17	Meeting between NCC and Highways England.	Key Topic and Outcome Further discussion on de-trunking principles. Highways England to provide cut-off date of when in programme de-trunking principles need to be Agreed
20/09/17	Meeting between NCC and Highways England.	Key Topic and Outcome Preferred route announcement discussed. Detrunking of A1 discussed. NCC Agreed to work with WSP regarding design for de-trunked section. Condition surveys of de-trunked section also discussed as well as NMU / cycling. Examples of previous de-trunking schemes to be provided by HE. NCC indicated southern extent of de-trunking only to extend to Jacksons Garage. NCC confirmed design of side roads to be to DMRB.
20/10/17	Highways Technical Meeting for Part A between NCC and Highways England.	Key Topics Meeting held with NCC. Key Outcomes Issues discussed were as follows: <ul style="list-style-type: none"> – Agreed that West Moor is to be widened as part of scheme for agricultural vehicles. NCC's Graham Fairs is Point of Contact to attend detailed design meetings with Wimpey. – Historical flooding problem at West View from surface runoff and Coting Burn. It was Agreed that the catchment area would be included in scheme drainage design;

Date	Form of Correspondence	Key Topics Discussed and Key Outcomes
		<ul style="list-style-type: none"> – It was Agreed that Priest Bridge would be retained for walking, cycling and horse riding access, with an action for Highways England to include it in the Walking, Cycling and Horse riding (WCH) assessment. NCC identified that access will also be required for maintenance, and Highways England Agreed to include the turning head in the preliminary design; – Request from NCC for parking provision outside Tritlington primary school to be considered by the design team; – Request from NCC that the red hatching on de-trunked section of the A1 is removed this would require new road surface. For Highways England to consider; – It was Agreed that the proposed new bridge over River Coquet will impact on existing holding pond located to the east of the A1 for the Scheme to account for in the drainage design; – It was highlighted by NCC that Felton Bridge requires strengthening to 40T, if traffic is to be diverted temporarily through Felton. NCC will require funding for this work. It was Agreed that the Construction Traffic Management Plan would seek to avoid this route (which it subsequently did); – Similarly, if traffic is to be temporarily diverted on to the A697, remedial measures will need to be implemented in advance. Historical speed problem on the A697 and longstanding issues at Longhorsley are for the scheme to consider within the Construction Traffic Management Plan; – De-trunking of A1 – NCC requested that the existing highway drainage be made good before handed over to NCC; and – NCC requested that a commuted sum be made available to cover the cost of the handover of the de-trunked section of carriageway. <p>HE to speak to their internal departments on the existing condition and commuted sum aspects to report back to NCC at future meeting.</p>
08/11/17& 21/11/17	Email Exchange between Gary Park (Environmental Protection Officer) NCC and Highways England	<p>Key Topics</p> <p>Introducing proposed assessment methodology (including approach to defining operational Study Area) for Part A.</p> <p>Key Outcomes</p> <p>The proposed baseline noise survey monitoring locations were set out by Highways England.</p> <p>Highways England proposed to undertake a detailed level of assessment in line with the DMRB HD 213/11. The methodology to derive the Study Area for Part A in accordance with DMRB HD 213/11 was also proposed.</p> <p>Gary Park confirmed that there were no issues raised by the proposed assessment methodologies.</p>
08/11/17	Meeting between NCC and Highways England.	<p>Key Topics</p> <p>Meeting held to update NCC following recent stakeholder meetings where the following issues were raised.</p> <p>Key Outcomes</p> <ul style="list-style-type: none"> – The alternative bus route and stop proposals for Part A, which had previously been shown to Arriva, were shared with NCC. It was Agreed that a mini park and ride is not expected to be required on the (then) M2F scheme. – Highways England also informed NCC of the recent blight claims received and advised on the next steps for Highways England to respond within two months.

Date	Form of Correspondence	Key Topics Discussed and Key Outcomes
08/11/17	Signage Meeting with NCC and Highways England.	<p>Key Topics</p> <p>Meeting held with NCC to discuss the road signage strategy for Part A including the proposed de-trunked section.</p> <p>Key Outcomes</p> <p>Proposed extents of the signage north and south of the Scheme were set out. Proposed destination names were challenged, and suggested amendments Agreed Destinations with less than five dwellings should not be signed. Agreed that tourist destinations to conform to TD 57/17. NCC asked that Lane Head Junction be included, and destination amendments made to current signs, but this was stated by Highways England to be outside the Scheme scope. NCC recommended that care should be taken for signs at compact grade separated junction, following driver confusion earlier that year. It was Agreed this would be incorporated at detailed design and reviewed at Road Safety Audit. Updated local area destination map to be available for next meeting.</p>
09/01/18	Meeting between the EA, NCC and Highways England.	<p>Key Topics</p> <p>Initial meeting held to discuss the approach to the water environment and flooding, including the approach to hydraulic assessment of watercourses, climate change, surface water, permitting, embankments, flood risk at Felton, Water Framework Directive Assessment and culvert design.</p> <p>Key Outcome</p> <p>The EA and NCC Agreed the approach to the hydraulic assessment, i.e. smaller watercourses and overland flow routes could be assessed using simple analysis whereas more complex analysis would use 1D modelling.</p> <p>The EA also confirmed that hydraulic modelling of the River Coquet would not be required.</p>
18/01/18	Meeting between NCC and Highways England.	<p>Key Topics</p> <p>Meeting held with NCC to update on the options for River Coquet Public Rights of Way (PRoW). NCC requested betterment to the northern PRoW and suggested that permanent stopping up of southern PRoW would be resisted by the NCC PRoW officer.</p> <p>Key Outcome</p> <p>Highways England Agreed that the Part B PROW options would be developed further and presented at a later date (see entries dated 22/05/19 & 04/07/19 in table 2-3, below).</p> <p>The turning head proposals for Arriva bus stops at Highlaws were discussed. NCC queried how misuse would be managed. It was Agreed that Highways England would consider their removal in the Scheme design to reduce the risk of misuse once requirements had been confirmed with Arriva (email 14/08/2018).</p>
22/02/18	Meeting between NCC and Highways England.	<p>Key Topics</p> <p>General Meeting with NCC including feedback on liaison with Tritlington Primary school over the proposed Part A construction compound.</p>

Date	Form of Correspondence	Key Topics Discussed and Key Outcomes
		<p>Key Outcome</p> <p>NCC suggested that there were opportunities for STEM educational activities with the school once construction starts.</p> <p>NCC identified an issue on A697 and an implication on the proposed removal of the Low Espley left-in/left-out to and from the A1. NCC to confirm status of track between Low Espley and A697 in order to allow further discussion.</p> <p>HE provided NCC with A556 Knutsford to Bowden de-trunking example; four lane single carriageway reduced to two lane single carriageway.</p> <p>In addition, the outcome from stakeholder meetings held with Eshott Airfield and Millhouse Developments were discussed with the NCC Planning team.</p>
07/03/18	Email to Specialist Planning Services – Northumberland County Council.	<p>Key Topics</p> <p>Consultation on the appropriateness of proposed viewpoint locations.</p> <p>Key Outcome</p> <p>NCC requested a site walkover to discuss viewpoint locations on site. Site visit arranged for and took place on 18th April 2018. During the site visit approximately 50% of viewpoints were visited.</p> <p>It was also requested that photomontages be prepared as part of the DCO submission. Highways England agreed to do this. The location of these viewpoints was subsequently agreed with NCC and submitted with the DCO application (see entry dated 01/05/18, below).</p>
08/03/18	Email exchange between Fearn Sims (On behalf of Highways England) and David Feige, NCC Principal Ecologist and AONB Officer.	<p>Key Topics</p> <p>Exchange of emails to confirm that from an NCC perspective, Part A will not impact on the Northumberland Coast AONB.</p>
11/04/18	Meeting between NCC and Highways England.	<p>Key Topics</p> <p>Meeting to discuss de-trunking and associated surveys on Part A. NCC confirmed they use Highway England's DMRB for VRS design standards. Highways England confirmed they will retain ownership of Priest Bridge and the redundant carriageway over the bridge.</p> <p>Key Outcomes</p> <p>It was agreed with NCC that the width of side roads was to be based on traffic counts. Confirmation was given by Highways England that the PMA option had been selected for Low Espley and the option to adjoin the A697 was not viable, based on NCC feedback.</p> <p>Highways England agreed to investigate changing the priority of Fenrother Lane junction on the de-trunked section.</p> <p>NCC confirmed that a single carrier pipe could be adopted for drainage design.</p> <p>HE to provide information on scope of pavement surveys on de-trunked section.</p>

Date	Form of Correspondence	Key Topics Discussed and Key Outcomes
		<p>It was agreed that the existing highway design suppresses use by cyclist and pedestrians. There is opportunity to improve/increase cycle and pedestrian provision on the de-trunked section. Highways England indicated they were looking to progress this through designated funding.</p> <p>Highways England confirmed that closed board fencing was the proposed option for segregating carriageways which are all at the same level. NCC queried if a hedgerow could be used. Highways England confirmed that this would be dependent on the available width and being able to secure access for maintenance.</p>
24/04/18 & 30/04/18	Email exchange between Fearn Sims (on behalf of Highways England) and Katherine Robbie (NCC Planning Services).	<p>Key Topic and Outcome</p> <p>Email exchange to confirm that NCC agreed that no nighttime assessments would be required for a number of viewpoints for Part A.</p>
24/04/18	Email from Highways England to Specialist Planning Services – Northumberland County Council.	<p>Key Topic and Outcome</p> <p>Consultation via email on the scope of the assessment relating to nighttime assessment. The omission of nighttime photography was proposed, with the assessment to be based on a written assessment only. The proposed method was accepted by NCC by email on the 30th April 2018.</p>
01/05/18	Email from Fearn Sims (on behalf of Highways England) to Katherine Robbie (NCC)	<p>Key Topics</p> <p>Follow up to the meeting 07/03/18 in respect of viewpoints. Revised viewpoint location plans were submitted to NCC for agreement.</p> <p>Key Outcome</p> <p>No objections to the viewpoints were received from Katherine Robbie (NCC Planning Services, email dated 10/05/18) and the viewpoints were used for the DCO submission (subject to the revision Agreed with NCC on 16/08/18, see entry below).</p>
10/05/18	Teleconference between NCC and Highways England.	<p>Key Topics</p> <p>Meeting with NCC to discuss the potential traffic management proposals in Part A and diversion routes for temporary closures of the A1 in relation to the Scheme.</p> <p>Key Outcome</p> <p>Discussed the potential for diverted traffic to use the A697 and cut across Moor Road and travel through Alnwick on the B3641. NCC noted that the timing and potential diversion on the A1068 coastal road will need to be confirmed if operational during tourist season.</p> <p>HE confirmed that these issues could be addressed through the CTMP.</p>
10/05/18	Email exchange between from Katherine Robbie (NCC Planning Services) and Fearn Sims (on behalf of Highways England).	<p>Key Topic and Outcome</p> <p>Confirmation of joint site visit between Highways England NCC to review proposed viewpoints for the Landscape and Visual Impact Assessment.</p>
10/05/18	Email from Glenn Shaw (Buildings Conservation Team), NCC to Highways England	<p>Key Topic and Outcome</p>

Date	Form of Correspondence	Key Topics Discussed and Key Outcomes
		Confirmation from NCC of Grade II listed buildings and other non-designated heritage assets that Part A might have an impact upon. Of the 65 listed buildings identified within the 1km Outer Study Area, 13 were identified as being potentially sensitive to changes in setting from the Scheme. It was Agreed that while all of the assets would be reviewed, where possible, in the site walkover, particular attention would be paid to these 13. In addition, two non-designated built heritage assets were identified as requiring scoping in.
24/05/18	Meeting between NCC and Highways England.	Key Topic and Outcome Highways England provided an update in relation to the de-trunking proposals on Part A and issued further information on highway maintenance boundaries following previous meeting discussions. Typical scheme highway cross-sections on the Scheme were debated. PMA width for Bywell Road on Part A was confirmed as 6.0m. In addition, Highways England provided feedback from stakeholder meetings held with Hoggs, Kelchers, Milner and Taylor Wimpey.
26/06/18	Meeting between NCC and Highways England.	Key Topics Meeting with NCC to discuss highway maintenance boundaries on Part A. As-builts for Parkwood subway on Part A confirmed as previously handed over. Key Outcome NCC believe Highways England should retain the link roads to the junction bridges and West Moor proposed roundabout. Queries still outstanding for Causey Park and Burgham Park bridges. Highways England to prepare layouts in a technical note (final versions Agreed show these to remain with NCC in TT.3 submitted at Deadline 1 in response to First Written Questions). NCC endorsed approaches for pavement survey residual life assessment and drainage assessment. HE confirmed condition survey for assets other than pavement and drainage will be undertaken at the appropriate time. NCC Agreed to provide a proposed typical section for the de-trunked A1. Noted that carriageway may need to be resurfaced after removal of red hatched areas. HE confirmed cycleway will be included in the new link road on east side linking to the de-trunked A1.
28/06/18	Email from Dale Rumney (NCC) to Ellie Briggs (on behalf of Highways England)	Email including copy of typical cross-section to illustrate the County Council's preferred layout for the de-trunked section of A1, incorporating narrowing of the carriageway and provision of both a footway and cycleway.
30/07/18	Email from Highways England to NCC Ecologist.	Key Topic Email to NCC regarding impacts to the Coquet River Felton Park Local Wildlife Site (LWS) as a result of Part A. Highways England confirmed that Part A would result in the loss of a small area of the LWS to facilitate the construction of a new bridge across the River Coquet and associated infrastructure. Highways England explained that the mitigation scheme would likely involve compensatory planting at a minimum of like-for-like (in area) to compensate for the loss. The Applicant confirmed that they would welcome comment.

Date	Form of Correspondence	Key Topics Discussed and Key Outcomes
		Key Outcome NCC provided a response via email on 03/08/2018 (see below).
31/07/18	Meeting between NCC and Highways England.	Key Topics Discussed de-trunking pavement survey dates options and Private Means of Access (PMA) on Hogg land and Barn Owl mitigation with NCC's Area of Outstanding Natural Beauty (AONB) officer on Part A. Key Outcome HE confirmed that they would consider these possibilities in developing the Scheme design for Part A.
30/07/18 & 03/08/18	Email exchange between Highways England and from David Feige (NCC Principal Ecologist and AONB Officer).	Key Topics Confirming the approach to mitigating the impacts of Part A on the Coquet River Felton Park Local Wildlife Site (LWS) Key Outcome David Feige of NCC confirmed that whilst the Coquet River Felton Park LWS is not designated as Ancient Woodland, NCC would nevertheless still expect to see replacement replanting, and that a ratio of 1:1 for this replanting would be too low. Highways England accepted this approach.
03/08/18	Email from NCC Ecologist to Highways England	Key Topic Reply to the email dated 30/07/2018 (see above) from Highways England regarding the impacts to the Coquet River Felton Park LWS as a result of Part A and the proposed compensation. Key Outcome NCC confirmed that whilst the area of woodland habitat within the LWS that would be impacted by Part A is not designated as ancient woodland, it supports ancient woodland indicator species and lies immediately adjacent to ancient semi-natural woodland that is designated as a Site of Special Scientific Interest (SSSI). As such, NCC stated that they would consider a 1:1 replacement to be a <i>“very long way short of what would be appropriate in this case.”</i>
05/08/18 & 09/09/18	Email exchange between Gary Park (Environmental Protection Officer), NCC and Highways England	Key Topics Email exchange confirming the location of sensitive receptors in relation to Part A (Northgate Hospital Site and Tritlington School). Key Outcome NCC confirmed the presence of two designated sites; the River Coquet and Coquet Valley Woodlands Site of Special Scientific Interest (SSSI) and the Coquet River – Felton Park (Local Wildlife and Geological Sites) at the northern end of Part A. NCC also suggested a discussion with NCC's Ecology team to confirm that the approach to the assessment of LWSs. These were subsequently confirmed via an exchange of emails with NCC Ecology team 23/10/18 (see below).

Date	Form of Correspondence	Key Topics Discussed and Key Outcomes
16/08/18	Email – Specialist Planning Services – Northumberland County Council.	<p>Key Topics</p> <p>Correspondence relating to the revision of a number of photomontage locations on the ground of Health and Safety – due to the method of capturing verified views it was not deemed practical to take verified views from previously identified viewpoint location located along the side of roads due to the narrow widths of existing grass verges.</p> <p>Key Outcome</p> <p>Revised locations accepted by NCC by email 16/08/18.</p>
24/08/18	Meeting between Nick Best, NCC and Highways England	<p>Key Topics</p> <p>Meeting held to discuss the scope and content for the Cultural Heritage assessment for the ES (Part A).</p> <p>Key Outcome</p> <p>The following was Agreed:</p> <ul style="list-style-type: none"> – The ES will be informed by a historic environment desk-based assessment, walkover survey and geophysical survey. – That Highways England would take a proportionate approach to the requirement to carry out additional geophysical surveys. This means that the requirement for additional surveys should be proportionate to the size of affected area and the quality of the results in the immediate area; – Due to the limitation of land access for intrusive works, trial trench evaluations would not be included within the scope of the ES chapter (Part A). – Agreement to explore further non-intrusive survey techniques to support the assessment. – Agreement that further discussions would be held.
31/08/18	Meeting between NCC and Highways England.	<p>Key Topics</p> <p>Meeting held to review the free flow design proposal of the new Fenrother junction within Part A. NCC queried proposals for the speed limit here and at Tritlington primary school.</p> <p>Key Outcome</p> <p>Further development from previous meeting on 31/07/18 on discussion of Part A and B's maintenance liabilities. Highways England confirmed that mitigation hedgerows will require a 3m maintenance strip and hedges are primarily the responsibility of the landowners on the trunk road.</p> <p>The PRow southern tie-in principles at the River Coquet within Part A previously discussed on 18 January 2018 were Agreed</p> <p>Highways England indicated investigating the option of including cycleway provision for the whole length of de-trunk and new link to Felton.</p>

Date	Form of Correspondence	Key Topics Discussed and Key Outcomes
05/09/18	Meeting between the EA, NCC and Highways England.	<p>Key Topics</p> <p>Meeting held to discuss the general design approach to the water environment and flood risk elements of Part A of the Scheme, including all watercourses and surface water flow paths with the exception of the River Coquet which was the topic of a separate meeting. This included designing all culverts for free flow conditions during the 1% AEP plus 25% climate change rainfall event, mammal passage, fish passage and mitigation measures.</p> <p>Key Outcome</p> <p>Culverts design principles were discussed and Agreed including the use of trash screens and scour protection.</p>
28/09/18	Skype meeting between NCC and Highways England.	<p>Key Topics</p> <p>Meeting to present the proposed Part A National Grid advanced diversion and related construction traffic. Highways England also provided an update on Part A's de-trunking and draft consultation report and confirmed that targeted consultation would be required for emerging mitigation measures.</p> <p>Key Outcome</p> <p>Further to previous de-trunking meeting 11/04/18, Part A's de-trunked design speeds to be confirmed by NCC based on proposed classification. Subsequently on 18/12/2020 NCC requested national speed limit be adopted. Highways England Agreed , subject to the results from the road safety audits undertaken at stages throughout the detailed design.</p>
23/10/18	Email from David Feige, Principal Ecologist and AONB Officer, NCC to Highways England	<p>Key Topic and Outcome</p> <p>Email confirming that Local Wildlife Sites (LWS) should be included within the environmental assessment of the impacts of Part A.</p>
01/11/18	Meeting between the EA, NCC and Highways England.	<p>Key Topic</p> <p>Meeting to discuss the flood risk and water environment elements of the proposed River Coquet Bridge with a view to understanding the requirement for and minimum criteria for hydraulic modelling, geomorphological assessment and Water Framework Directive (WFD) assessment.</p> <p>Key Outcome</p> <p>The work required for the DCO application was Agreed</p>
07/11/18	Meeting between NCC and Highways England.	<p>Key Topic</p> <p>Meeting to present to NCC the proposed environmental mitigation measures for Part A.</p> <p>Key Outcome</p>

Date	Form of Correspondence	Key Topics Discussed and Key Outcomes
		<p>NCC happy with details provided but queried the appearance of anti-reflective fencing at locations with insufficient width to accommodate hedgerows between carriageways. Highways England confirmed that the width and access for maintenance will determine the type of anti-reflective barrier to be used.</p> <p>NCC also requested an update on the proposed utility diversion at Causey Park within Part A as they are likely to field public queries. Details provided to NCC.</p> <p>HE noted that cyclist and environmental options for designated funds are being developed for review at the end of the year</p>
02/04/19	Meeting between NCC and Highways England.	<p>Key Topic</p> <p>Meeting held to update NCC on Part A's lane configuration south of West Moor and its anti-reflective fencing and National Grid works.</p> <p>Key Outcome</p> <p>NCC requested confirmation of the height of the proposed close board fencing. Highways England stated that this would be confirmed at detailed design.</p> <p>Ownership and maintenance of hedges in this section to be confirmed. NCC re-iterated importance of cycleway on de-trunked section. Highways England confirmed inclusion of cycleway in DCO application.</p> <p>Part A's National Grid diversion at Causey Park previously discussed confirmed as moved back 12 months. NCC to be informed of updated dates for the revised diversion construction.</p>
22/05/19	Meeting between NCC and Highways England.	<p>Key Topic and Outcome</p> <p>Meeting held with NCC to discuss Memorandum of Understanding (MoU). This document is intended to accompany the SoCG and sets out the details of the de-trunking aspects of Part A that are to be Agreed</p> <p>NCC requested written confirmation that cycleway would be provided from West Moor to Tritlington junction</p>
06/06/19	Email exchange between Alex Grassam (on behalf of Highways England) and Karen Derham (County Archaeologist), NCC.	<p>Key Topic</p> <p>Email exchange to clarifying the scope of the proposed Written Scheme of Investigation (WSI).</p> <p>Key Outcome</p> <p>It was Agreed to produce outline WSI for post-determination trial trenching across Part A and a separate WSI for an Archaeological Strip, Map and Sample Excavation (National Grid Diversion Works).</p> <p>The draft WSIs were submitted to NCC for comments.</p> <p>Minor comments made by Karen Derham (NCC Archaeology) via email dated 06/06/19 proposed some small revisions to the suggested WSI for the trial trenching. These revisions were accepted by Highways England and were incorporated into the subsequent WSI [APP-225].</p>

Date	Form of Correspondence	Key Topics Discussed and Key Outcomes
05/09/19	Meeting between NCC and Highways England.	<p>Key Topic Meeting held to discuss advanced construction activities within Part A, comprising the demolition of Northgate House and National Grid Diversions.</p> <p>Key Outcome Highways England presented recent agreement of blight for Northgate House and that the demolition would be early in the construction programme. It was confirmed that approval would be required from the local planning authority for this advanced construction activity. The National Grid diversion is due to start on site in March 2020. Advanced notifications to be shared with NCC's Streetworks team. Temporary compound required for Ground Investigation surveys at the River Coquet, with NCC approval.</p>
05/12/19	Meeting between NCC and Highways England	<p>Key Topic and Outcome HE to provide NCC with copy of Memorandum of Understanding for de-trunking section. Discussion regarding progress with designated funds for cycleway</p>
07/11/19	Meeting between NCC and Highways England	<p>Key Topic and Outcome Meeting held to discuss proposed advance utility diversions. NCC made aware that National Grid and Highways England would be undertaking stakeholder meeting the following week for these works.</p>
12/02/20	Meeting between NCC and Highways England	<p>Key Topic and Outcome Copy of draft Memorandum of Understanding for de-trunking section now received by NCC. NCC to review and respond</p>
22/01/20	Email exchange between Gary Park (Environmental Protection Officer, NCC) and Highways England	<p>Key Topics and Outcome Highways England confirmed the final layout for Part A and NCC confirmed that the human and ecological receptors for Part A remain as previously Agreed</p>
13/02/20	Meeting between NCC and Highways England.	<p>Key Topic Meeting held to discuss the progress of archaeological works at Causey Park (within Part A.)</p> <p>Key Outcome HE tabled a programme for ground investigation surveys at the River Coquet and a high-level construction sequence for the Scheme to allow NCC to compare against their planned works.</p>
15/02/21	Meeting with NCC and the Applicant	<p>Discussion regarding the Construction Traffic Management Plan.</p> <p>Key Topic Discussed the concerns previously raised by NCC and the subsequent responses provided by the Applicant ahead of the meeting.</p>

Date	Form of Correspondence	Key Topics Discussed and Key Outcomes
		Key Outcome Unable to close out most issues during the meeting, with both parties taking actions away. NCC to confirm whether or not their concerns have been fully addressed and items can be closed out.
17/02/21	Meeting with NCC and the Applicant	Discussion regarding the Public Rights of Way proposals. Key Topic Follow up meeting to discuss the changes made to the Rights of Way and Access Plans and dDCO Schedules following comment from NCC. Key Outcome NCC's Infrastructure Records Manager confirmed that they are satisfied with the Applicant's responses and updates to the Rights of Way and Access Plans and dDCO Schedules, and that there are only a couple of minor issues outstanding.
03/03/21	Meeting with NCC and the Applicant	Key Topic Meeting to discuss the proposed maintenance boundaries Key Outcome NCC raised issues surrounding the stopping up of highways near Detention Basin 20 and Highlaws Junction, particularly with regard to ownership following completion of the scheme and whether this should be covered off in the DCO. The Applicant took this issue away and is to respond.
16/04/21	Meeting with NCC and the Applicant	Key Topic Follow up meeting to discuss the proposed maintenance boundaries and changes made to the design in response to NCC comments from the previous meeting on 03/03/21. Key Outcome It was agreed that the maintenance limits of adoption could be agreed at detailed design. However, a note is to be also produced during the DCO Examination period to state the agreed methodology of determining adoption and to act as a record of what has been agreed at this stage and what can be agreed at the detailed design stage.

Table 2-3 – Record of Engagement in Relation to Part B

Date	Form of Correspondence	Key Topics Discussed and Key Outcomes
11/04/18	Meeting between NCC and Highways England.	Key Topic Meeting between NCC and Highways England to discuss design standards and final design details for Part B.

Date	Form of Correspondence	Key Topics Discussed and Key Outcomes
		<p>Key Outcome</p> <p>NCC confirmed that they use Highway England's DMRB for VRS design standards. It was agreed that the width of side roads was to be based on traffic counts.</p> <p>NCC confirmed a single carrier pipe could be adopted for drainage design.</p> <p>Highways England confirmed that close boarded fencing was the proposed option for segregating carriageways which are all at the same level. NCC queried if a hedgerow could be used. Highways England confirmed that this would be dependent on the available width and being able to secure access for maintenance.</p> <p>Highways England to develop an assessment for the requirements for the location selection of the accommodation bridge on Part B. Agreed to be assessed as part of the WCH Assessment Report (WCHAR) for Part B.</p>
07/06/18	<p>Email from Stephen Wigham (on behalf of Highways England) to Gary Park (Environmental Protection Officer) at NCC.</p> <p>Email from Gary Park (Environmental Protection Officer) NCC to Stephen Wigham (on behalf of Highways England).</p>	<p>Key Topic</p> <p>Stephen Wigham on behalf of Highways England emailed Gary Park of NCC to set out the proposed noise and vibration assessment methodology (including approach to defining operational Study Area) for Part B proposing baseline noise measurement locations and requesting information on specific planning policies, known local sensitive receptors (other than dwellings) and sources of known noise and vibration complaint.</p> <p>Highways England proposed to undertake a detailed level of assessment in line with the DMRB HD 213/11. The methodology to derive the Study Area for Part B in accordance with DMRB HD 213/11 was also proposed.</p> <p>Key Outcome</p> <p>Response from Gary Park of NCC suggested slight changes to proposed measurement locations and confirmed that there are no known sources of noise and vibration complaint and stating that there are no known particularly sensitive receptors other than dwellings within the vicinity of Part B. He also confirmed that no issues were raised regarding the proposed assessment methodologies.</p>
31/07/18	Meeting between NCC and Highways England.	<p>Key Topic and Outcome</p> <p>Highways England provided an overview of the design development and drainage strategy on Part B, and confirmed this to be similar in approach to Part A.</p>
22/08/18	Email from NCC to Highways England.	<p>Key Topic</p> <p>NCC ProW Officer confirmed their support for the Broxfield overbridge option for Part B, subject to mitigation for the loss of the public right of way crossings to avoid transferring WCH road user risk to the B6341 and raising the possibility of downgrading the BOAT 13 to bridleway status.</p> <p>Key Outcome</p> <p>The Broxfield overbridge option was accepted by Highways England and the suggested mitigation accepted.</p>

Date	Form of Correspondence	Key Topics Discussed and Key Outcomes
28/09/18	Skype meeting between NCC and Highways England.	Key Topic Meetings held with NCC's ProW officer to discuss the principles of provision on Part B, with further developments to be presented at a later meeting. The Arriva X15 bus route which would be impacted by Part B was discussed. Highways England confirmed that the bus stop proposals were to be finalised.
17/10/18	Exchange of emails between Gary Park (Environmental Protection Officer, NCC) and Nicola Bolton (on behalf of Highways England)	Key Topics Alternative noise measurement locations suggested by Highways England due to previous consultation feedback and proposed additional construction compound. NCC stated that the proposed changes / additions to the noise measurement locations were acceptable. Key Outcome Noise measurement locations were subsequently implemented in the surveys.
01/11/18	Meeting between EA, NCC and Highways England.	Key Topic Initial meeting to introduce Part B of the scheme, in relation to flooding and water issues. This included a discussion around the modelling approach, Water Framework Directive and generic design considerations. All agreed the approach to be taken.
06/12/18	Meeting between NCC and Highways England.	Key Topic Meeting to discuss the options for the proposed accommodation bridge at either Broxfield or Heckley Fence within Part B, to be shown at consultation. Key Outcome The meeting also discussed planning related matters with respect to proposals for development by Northumberland Estates (within Part B) and latest NCC activities on these matters. NCC undertook to review Parish Council report on Denwick bypass and provide update at next meeting on 23/1/19.
23/01/19	Meeting between NCC and Highways England.	Key Topic Discussions to review the options for the proposed accommodation bridge at either Broxfield or Heckley Fence within Part B. NCC confirmed that they were happy with the details provided, but queried what residents at Heckley Fence will think. A follow up meeting with NCC's PROW Officer was suggested. NCC to provide timescales for development of the Local Plan application.
29/01/19	Email exchange between David Feige (Principal Ecologist and AONB Officer), NCC and Sophie Lewis (on behalf of Highways England).	Key Topic Confirmation from NCC that Part B will have ' <i>will not have a significant effect on the special qualities of the Northumberland Coast AONB.</i> '

Date	Form of Correspondence	Key Topics Discussed and Key Outcomes
16/05/19	Telecon between NCC and Highways England.	<p>Key Topic</p> <p>Telecon to discuss the flooding issues and modelling results of the Kittycarter Burn.</p> <p>Key Outcome</p> <p>All agreed modelling approach and refinements required – see entry for 29/05/19, below.</p>
22/05/19	Meeting between NCC and Highways England.	<p>Key Topic</p> <p>Meeting held with NCC where ProW officer confirmed that, if the Heckley Fence accommodation bridge location were selected, the byway would need to be diverted.</p> <p>Key Outcome</p> <p>In addition, the proposed archaeology surveys within Part B were discussed. It was agreed that NCC would be advised of the dates of excavations, to keep the County Archaeologist involved.</p>
29/05/19	Telecon between NCC and Highways England.	<p>Key Topic</p> <p>Follow up to the meeting 16/05/19: a telecon to discuss the flooding issues and modelling results of the Kittycarter Burn.</p> <p>Key Outcome</p> <p>All agreed modelling approach was acceptable.</p>
17/06/19	Email exchange between Katherine Robbie (Senior Planning Officer, NCC) and Fearn Sims (on behalf of Highways England).	<p>Key Topic</p> <p>HE sought confirmation of viewpoints for Part B.</p> <p>Key Outcome</p> <p>Email exchange with NCC, resulting in NCC's confirmation that the suggested viewpoints for Part B were representative.</p>
26/07/19	Exchange of emails between Alex Grassam (on behalf of Highways England) and Karen Derham (County Archaeologist), NCC to Highways England.	<p>Key Topic</p> <p>Submission of the results of the geophysical survey for Part B by Alex Grassam (on behalf of HE) to Karen Derham (NCC).</p> <p>Key Outcome</p> <p>Following discussion, and based on the results of the geophysical surveys, it was agreed that archaeological evaluation in the form of trial trenching was required in two locations to inform the Application:</p> <ul style="list-style-type: none"> – Land adjacent to Scheduled Monument Camp at West Linkhall (NHL 1006500) – Land adjacent to North Charlton Medieval Village and Open Field System (NHL 1018348) <p>Confirmation from NCC that the proposed locations for trial trenching around South Charlton (which had been slightly amended from those originally suggested by NCC to account for the topography of the land) were acceptable to NCC.</p>

Date	Form of Correspondence	Key Topics Discussed and Key Outcomes
		The scope of the archaeological evaluations was set out in WSIs which were revised by Alex Grassam following the conclusion of the Geophysical Walkover Survey and submitted to NCC for approval. The final WSIs are submitted as Appendix 8.5: Written Scheme of Investigation for an Archaeological Trial Trench Evaluation Part A [APP038] and Appendix 8.5 Draft Written Scheme for Investigation for Post DCO-Consent Trial Trenching Part B [APP295]
07/11/19	Meeting between NCC and Highways England	Key Topic Meeting held to discuss proposed advance utility diversions. NCC made aware that National Grid and Highways England would be undertaking stakeholder meeting the following week for these works.
18/12/19	Email to David Laux (Head of Technical Services) from Highways England.	Key Topic Further to meeting on 07/11/19, email setting out the design change relating to the maintenance access route for one of the proposed detention basins (DB22) at the southern end of Part B. NCC agreed to the proposed design change at Liaison meeting 05/12/2019. This was changed with access now proposed from the main carriageway.
06/02/20 & 11/02/20	Email exchange between Karen Derham (County Archaeologist), NCC and Highways England.	Key Topic During consultation, it was agreed that outline WSI would be produced for off route sections of Part B for post-determination trial trenching to inform the requirement for archaeological mitigation. It was agreed that a second WSI was also required for a building recording on a non-designated farmstead (Charlton Mires) which will be demolished. Key Outcome The draft WSIs for Part B were submitted to NCC for consultation. Detailed discussion between Alexandra Grassam (on behalf of Highways England) and Karen Derham (NCC) were held over the exact locations and orientation of the proposed trial trenches identified in the draft WSI. This resulted in agreed amendments to the proposed locations of the trial trenches.
12/10/20	Meeting with NCC and the Applicant	Key Topic and Outcome Discussion of detailed review of the findings of the LVIA for Part B [APP-045], comments provided by NCC.
01/12/20	Email correspondence with NCC and the Applicant	Key Topic Detailed response provided to the comments raised by NCC on the LVIA for Part B [APP-045]. Issues currently under discussion.
14/01/21	Meeting with NCC and the Applicant	Detailed discussion around issues identified with the Rights of Way and Access Plans [REP2-003] and DCO [REP2-004 and 005] Schedules. Key Topic NCC stated that the proposed local access roads serving East Linkhall, West Linkhall and Rock South Farm should not have 20mph speed limits are applied. They should be national speed limit.

Date	Form of Correspondence	Key Topics Discussed and Key Outcomes
		<p>NCC took the view that it was unclear from the DCO plans which roads are to be adopted and which are not. Also agreed that the existing unclassified local access road (U3004) serving Rock South Farm is not shown as being stopped up on the Rights of Way and Access Plans, but the road is to be handed over to adjacent landowners as part of the Scheme.</p> <p>Key Outcome The Applicant confirmed that the national speed limit is to be applied to the proposed local access roads serving East Linkhall, West Linkhall and Rock South Farm. agreed to update the Traffic Regulation Plans accordingly.</p> <p>A scheme overview plan showing the extent of roads to be adopted was produced and issued to NCC on 08/02/21.</p> <p>The Rights of Way and Access Plans [REP2-003] and DCO Schedules [REP2-004 and 005] were updated for Deadline 02 to show existing unclassified local access road (U3004) serving Rock South Farm was updated to be stopped up.</p>
15/02/21	Meeting with NCC and the Applicant	<p>Key Topic Discussion regarding the Construction Traffic Management Plan. Discussed the concerns previously raised by NCC and the subsequent responses provided by the Applicant ahead of the meeting.</p> <p>Key outcome Unable to close out most issues during the meeting, with both parties taking actions away. NCC to confirm whether or not their concerns have been fully addressed and items can be closed out.</p>
17/02/21	Meeting with NCC and the Applicant	<p>Discussion regarding the Public Rights of Way proposals.</p> <p>Key Topic Follow up meeting to discuss the changes made to the Rights of Way and Access Plans and dDCO Schedules following comment from NCC.</p> <p>Key Outcome NCC's Infrastructure Records Manager confirmed that they are satisfied with the Applicant's responses and updates to the Rights of Way and Access Plans and dDCO Schedules, and that there are only a couple of minor issues outstanding.</p>
24/2/21	Email and telephone calls with NCC (Mary Fisher) and the Applicant	<p>Details discussed on the updates to the agreement for landscape and visual issues.</p> <p>Key Topic Issues of sensitivity of landscape character, impacts on communities and mitigation measures to reduce the effects were discussed.</p> <p>Key Outcome Agreement was reached on a number of points, including confirmation of the mitigation strategy for Parts A and B, and the absence of material differences between the assessment undertaken by the Applicant and NCC.</p>

Date	Form of Correspondence	Key Topics Discussed and Key Outcomes
03/03/21	Meeting with NCC and the Applicant	<p>Key Topic Meeting to discuss the proposed maintenance boundaries.</p> <p>Key Outcome The Applicant took the following actions away:</p> <ul style="list-style-type: none"> – East Linkhall Access Road to be widened from 4.5m wide single lane with passing bays to become 6.0m wide two-lane carriageway. – Length of existing road to the north of East Linkhall Access Road tie-in (Ch.60200 to Ch.603000) is to be de-trunked – dDCO Schedules to be updated accordingly. NCC ask that Shipperton Bridge to be maintained by HE, similar to the arrangement at Priest Bridge on Part A. – West Linkhall Access Road pinch point – length and width of single lane section of road to be reduced if possible. – Turning head to be provided at northern end of West Linkhall Access Road. – Rock South Farm Access Road carriageway width to be reduced from 4.5m. – Positive drainage to be provided on access roads for East Linkhall, West Linkhall and Rock South Farm.
16/04/21	Meeting with NCC and the Applicant	<p>Key Topic Follow up meeting to discuss the proposed maintenance boundaries and changes made to the design in response to NCC comments from the previous meeting on 03/03/21.</p> <p>Key Outcome It was agreed that the maintenance limits of adoption could be agreed at detailed design. However, a note is to be produced during the DCO examination period to state the agreed methodology of determining adoption and to act as a record of what has been Agreed at this stage and what can be agreed at the detailed design stage.</p> <p>NCC are to assess the possibility of adopting Rock South Farm Access Road without positive drainage provisions. The Applicant has provided additional information to NCC to assist them with their assessment on 22nd April 2021.</p>
26/04/21	Email correspondence with NCC and the Applicant	<p>Key Topic Agreement on the outstanding issues relating to landscape that were identified as being not agreed or under discussion.</p> <p>Key Outcome The remaining items relating to the approach taken and the identification of significant effects is now agreed, additionally the drafting of a LEMP is now accepted and agreed.</p>

2.1.3. It is agreed that this is an accurate record of the key meetings and consultation undertaken between (1) the Applicant and (2) NCC in relation to the issues addressed in this SoCG.

3 ISSUES

Table 3-1 – Issues Related to the Draft Development Consent Order

Item	Draft DCO Item	Northumberland County Council Comment	Highways England Response	Status
1.	Articles	NCC is generally satisfied with the provisions of the draft DCO and consider that they are satisfactory and appropriate. Specific issues are discussed below.	Agreed	Agreed
2	Schedules	NCC would like to see the wording of Schedules 1 and 3 revised to require the provision of enhanced Public Rights of Way as part of the Scheme. The proposed wording is included in NCC's Deadline 8 submission document REP8-028b.	The Applicant does not accept that the proposed amendments are required to mitigate the impact of the Scheme. Some of the proposed changes are not deliverable within the Order Limits of the Scheme.	Not Agreed
3	7 – (Limits of Deviation)	NCC is content with the limits of deviation contained in Article 7, subject to NCC being consulted on any proposed amendments made under this article.	Agree. In practice, NCC would be consulted on any amendments made under this Article prior to their submission to the Secretary of State.	Agreed
4	12 – Street works	Art 12(1) – NCC is satisfied that this Article is appropriate provided that the Applicant/contractor complies with the requirements of the Traffic Management Act 2004 and the New Roads & Street Works Act 1991 and specifically S60 – General duty of undertakers to cooperate. Any streets outside the Order will be subject to the requirements under the Northumberland County Council Works Permit Scheme.	Agreed. This requirement will be complied with.	Agreed
5		Art 12(1)(b) – It is agreed that the Article should be restricted to specific streets as set out in a Schedule although the Schedule should include the Road Classification (including C and U road classification) for clarity and ease of reference.	It is not considered that it is appropriate to include a Schedule in relation to the powers under Article 12. The definition of “streets” is very wide, and the list would require to be very extensive. The extent of affected streets is clear from the application plans. It is understood that NCC now accept this position.	Agreed
6		It is agreed that the powers shall be exercised with the consent of the Street Authority subject to consultation to ensure the Street Authority is fully aware of the powers being exercised to ensure no conflict between other authorisations from the Street Authority under their existing powers.	These are standard powers required for construction of the road which would be authorised by the DCO. It is not appropriate for such works to be subject to the consent of the street authority. The protection of NCC is protected by other provisions in the Order. It is understood that NCC now accept this position.	Agreed
7		Subject to the points raised above, it is our view that the Article is acceptable combined with the requirements for the Applicant/Contractor to adhere to the requirements of the Traffic Management Act 2004 and the New Roads and Street Works Act 1991.	The Applicant agrees that the requirements of the 2004 Act and the 1991 Act will be complied with.	Agreed

Item	Draft DCO Item	Northumberland County Council Comment	Highways England Response	Status
8	Article 14 - Classification of roads etc.	NCC would like Article 14 (2) be altered to read: <i>“From the date on which the roads described in Part 1 (trunk roads) of Schedule 3 (classification of roads, etc) become trunk roads, those roads specified in Part 2 (roads to be de-trunked) of Schedule 3 shall cease to be trunk roads as if they had become so by virtue of an order under section 10(2) of the 1980 Act specifying that date as the date on which they were to cease to be trunk roads and, subject to those roads being in such state of repair as is reasonably satisfactory to the local highway authority, shall vest in the local highway authority.”</i>	The Applicant accepts the proposed wording of this Article. This wording is now incorporated into the draft DCO [REP8-005].	Agreed
9	Article 16 – Permanent stopping up and restriction of use of streets, public rights of way and private means of access	Art 16(3)- NCC's preference is that the term “stopping up” to be used consistently through the document. This should be preceded by the word temporary or permanent depending on what is being proposed.	It is understood that NCC now accept that it is appropriate that there is reference to extinguishment of public rights of way.	Agreed
10		NCC has found a number of drafting errors in Article 16 and on the accompanying plans and also considers that the Article is confusing in the way that the proposals for the rights of way network are set out. Details of these drafting errors are set out at NCC05 attached to this document.	These have been reviewed with NCC and revisions made to the draft DCO to address [REP3-004].	Agreed
11		The principles set out within Article 16 are generally agreed with however, clarification is required from the Applicant in relation to the precise nature of the Stopping Up and the resultant status/ownership of the stopped up highway. Meeting required to formally establish exact boundaries between the Local and Strategic Road Networks.	The Applicant and NCC have now agreed a maintenance boundary methodology which will include the details of stopping up boundaries.	Agreed
12	Article 17 – Access to works	The proposed wording was previously used by NCC for the Morpeth Northern Bypass DCO granted in 2015. NCC is satisfied with the proposed article but require that <i>“with the consent of the Street Authority subject to consultation”</i> is added to the provision.	The additional wording is not considered necessary and the position of NCC is protected by other provisions in the DCO. It is understood that NCC now accept this position.	Agreed
13	Article 22 – Powers in relation to relevant watercourses	NCC is satisfied with the wording of this Article and has does not request any amendments to the wording.	Agreed.	Agreed
14	Article 23 – Discharge of water	NCC is satisfied with the wording of this Article and has does not request any amendments to the wording.	Agreed.	Agreed
15	Article 28 – Time limit for exercise of	NCC is satisfied with the wording of this Article and has does not request any amendments to the wording.	Agreed.	Agreed

Item	Draft DCO Item	Northumberland County Council Comment	Highways England Response	Status
	authority to acquire land compulsorily			
16	Article 40 – Felling or lopping of trees and removal of hedgerows	NCC is satisfied with this Article but is keen to ensure that works are carried out to British Standards and at a time of year that avoids seasonal constraints.	Agreed. The works will be carried out in accordance with British Standard 5837 (<i>'Trees in Relation to Design, Demolition and Construction'</i>) to ensure that trees and their root systems will be protected. This is captured in in Commitment SL5 of the outline CEMP [REP3-013]	Agreed
17	Requirements	NCC is satisfied that the impacts of the Scheme are capable of being appropriately controlled by requirements contained within any DCO granted.	Agreed	Agreed
18		With the exception of Requirement 17, (below), NCC is generally satisfied that the wording of the proposed requirements is acceptable and will appropriately and satisfactorily control and mitigate the environmental impacts of the Scheme.	Agreed	Agreed
19		NCC welcomes requirements 9 (Archaeological Remains) and 10 (Safeguarding of Listed Milestones) of the draft DCO. NCC further considers that these requirements are sufficient to safeguard features of Archaeological and Historic interest.	Agreed	Agreed
20	Requirement 17	<p>NCC would prefer the LEMP commitments to be set out in a standalone document and not contained within the wider CEMP.</p> <p>NCC is also concerned that the wording of Requirement 17 in the draft DCO submitted at Deadline 8 [REP8-005] makes the submission of a LEMP a matter that is at the discretion of the Applicant.</p> <p>NCC would like the wording of Requirement 17 amended so that if the submitted CEMP does not include all the provisions that one would normally expect to see in a LEMP, and the Applicant is not minded to submit a LEMP, NCC has a mechanism for making their views known to the Secretary of State and that obliges the Secretary of State to consider them when discharging this Requirement.</p>	<p>The Applicant considers that there is no requirement for the LEMP to be a standalone document, and that these matters can be satisfactorily dealt within the CEMP.</p> <p>The applicant agrees that the wording of the Requirements should be reviewed so that if there is a disagreement on the need for a LEMP then the matter requires to be resolved by the Secretary of State, who would have the submissions of NCC to refer to in making a decision. This has now been included in revised requirements 4 and 17.</p>	Not Agreed
21	Definitions	NCC does not object to the definition of “commencement” that has been used in the draft DCO [REP8-005].	Agreed	Agreed

Table 3-2 – Issues Related to the Scheme

Item	Document	NCC Position	Highways England Response	Status
1.	Economic and Social Effects			
1.1	Case for the Scheme [APP-344]	<p>Northumberland County Council recognises the benefits of this project. The Dualling of the A1 is a long ambition and NCC is supportive of the proposal, in principle.</p> <p>The principle of the Scheme is supported in both adopted and emerging planning policy as well as a of economic and transport strategies and documents that are material to the determination of planning applications. Individual environmental impacts are considered below.</p> <p>There is an identified “need” for the Scheme confirmed in both planning and transport policy. This is an ongoing need that remains unaltered by the ongoing Covid crisis.</p> <p>There dualling of the A1 will have a range of benefits. The Scheme will help improve journey times, and journey reliability.</p> <p>The current single carriageway stretches of the A1 currently suffers from major problems with slow moving vehicles causing disruption. The single carriageway stretches are more vulnerable to accidents and are harder to maintain without causing significant disruption.</p> <p>The Scheme will also improve journey time and will remove a barrier to economic investment in the region. For this reason, the Scheme will be important for economic growth and tourism.</p> <p>The A1 a currently barrier to east west traffic flows (including non-motorised uses). The at grade crossings will help to address this issue and will also be a significant benefit providing a safer means of crossing the A1.</p>	Agreed.	Agreed
1.2		NCC supports the proposed Scheme, subject to appropriate mitigation of any unacceptable environmental impacts.	Agreed	Agreed
1.3		<p>For Part A the southern (approximately) half of the length falls within the general extent of the Green Belt, as set out at 1.4, below.</p> <p>Much of the remaining length of the route is not covered by any designation, with the main exception being the natural and landscape value clearly attributed to the areas on either side of the Coquet crossing. The Proposals Map from Local Plan shows that the southern section, immediately north of the Coquet crossing, was designated an AHLV under saved Policy RE17.A designated Wildlife Corridor that follows the River Lyne.</p>	Agreed	Agreed
1.4		A substantial portion of Part A of the Scheme lies within the Green Belt defined by Policy S5 of the Northumberland County and National Park Joint Structure Plan. Whilst this policy does not specifically define Green Belt boundaries, the Green Belt Boundaries defined in	The Applicant accepts this. The Applicant is happy to accept that the Proposal Map that forms part of the emerging Northumberland Local Plan provides a	Agreed

Item	Document	NCC Position	Highways England Response	Status
		the emerging Northumberland Local Plan form a reasonable and logical illustration of the Green Belt boundaries to the north of Morpeth defined in Policy S5.	reasonable illustration the Green Belt around Morpeth contained in Structure Plan Policy S5.	
1.5		The Scheme comprises ‘inappropriate development’ within the Green Belt, as defined in the NPPF. However, it is considered that the harm to the Green Belt is significantly outweighed by the relevant other considerations and very special circumstances can be demonstrated in line with the requirements of Paragraph 144 of the NPPF.	Agreed	Agreed
1.6		There is no inherent conflict between the principle of dualling the A1 and the designation of Green Belt to the north of Morpeth. Both policies were promoted equally and in parallel in the Structure Plan, albeit that only Policy S5 was “saved” and remains part of the current development plan.	Agreed	Agreed
1.7		The only area specific designation, shown on the Alnwick Local Plan proposals map is another of the Area of High Landscape Value that abuts the west side of the A1, towards the northern end of Part B	Agreed	Agreed
1.8		In summary, for Part B, the roadline for part B has no allocations or designations that would be ‘showstoppers’.	Agreed	Agreed
1.9		The Scheme compound area will impact on Lionheart Enterprise Park. This impact is however considered to be acceptable in principle.	Agreed. The Applicant confirms that, as set out in the Applicant’s Response to ExA’s First Written Questions [REP1-032], the amount of land required for the compound has been reduced. In practice land take required will be less than identified in Chapter 2 of the ES [APP-037].	Agreed
1.10		Community benefits will accrue from the Scheme and it is accepted that these will contribute positively to the planning balance.	Agreed	Agreed
1.11		The Scheme will help to support the building of a strong, responsive and competitive economy through the reduction in travel time and by helping to bring businesses, residents and employees closer together across the County. To the north of Morpeth, the single carriageway nature of the A1 trunk road has contributed to Alnwick and places further north having a much more remote character with reduced opportunity to access work and metropolitan services offered by the Tyneside conurbation and, to the north, Edinburgh.	Agreed	Agreed
1.12		The inclusion of features to protect human health such as new junctions and linkages between severed rural areas will contribute to community, as well as economic, wellbeing	Agreed	Agreed
1.13		In terms of infrastructure, a detailed options exercise was undertaken before the current Scheme was arrived at and it is considered that the solution is probably the optimal one in	Agreed	Agreed

Item	Document	NCC Position	Highways England Response	Status
		terms of the use of existing infrastructure – reuse of existing carriageway areas, drainage solutions etc.		
1.14		A number of studies have been undertaken across a range of different transport modes and from a variety of perspectives which demonstrate the need and the benefits of dualling the A1.	Agreed	Agreed
1.15		The Council considers that the proposed scheme will contribute to economic growth both during the construction period and thereafter. It is anticipated that the improved accessibility throughout the A1 corridor will make towns and sites in Northumberland more attractive to new businesses and attract further investment for improvements at existing sites.	Agreed	Agreed
1.16		The full dualling of the A1 to Ellingham is a ' <i>committed Scheme</i> ' within the Road Investment Strategy.	Agreed	Agreed
1.17		The NPS NN was published by the DfT in December 2014 and sets out the need for, and Government's policies for delivering NSIP developments on the national road network.	Agreed	Agreed
1.18		Paragraph 2.2 of the NPS NN recognises that there is a ' <i>critical need</i> ' to improve the national road and rail networks to address road congestion and crowding on railways.	Agreed	Agreed
1.19		The Government has concluded that at a strategic level there is a ' <i>compelling need</i> ' for development on the national networks, as confirmed in paragraph 2.10 of the NPS NN. The same paragraph confirms that ' <i>The Examining Authority and the Secretary of State should therefore start their assessment of applications for infrastructure covered by this NPS on that basis</i> '.	Agreed	Agreed
1.20		Paragraph 2.22 of the NPS NN confirms the importance of improving the road network as without doing so ' <i>it will be difficult to support further economic development, employment and housing and this will impede economic growth and reduce people's quality of life. The Government has therefore concluded that at a strategic level there is a compelling need for development of all national road networks.</i> '	Agreed	Agreed
1.21		The NPS NN sets out that, subject to the detailed policies and protections contained in the NPS and the legal constraints set out in the 2008 Act, there is a ' <i>presumption in favour</i> ' of granting development consent for national network NSIPs that fall within the need for infrastructure established in the NPS NN.	Agreed	Agreed
Environmental Impact Assessment				

Item	Document	NCC Position	Highways England Response	Status
2.	Cumulative Effects			
2.1		<p>The dualling of the A1 presents a major opportunity in the county and the Scheme should not miss opportunities to improve the environment and accessibility in this part of the county.</p> <p>The local impacts and their cumulative impacts caused by the scheme have been appropriately considered and adequately addressed by the Applicant in Chapter 16: Assessment of Cumulative Effects of the ES [APP-062].</p>	Agreed. The Applicant does not consider that there are any unacceptable environmental impacts of the Scheme, either individually or cumulatively.	Agreed
3.	Air Quality			
3.1	Chapter 5 of the ES Part A and Part B [APP-040 and APP-041] and Appendix 16.4 Air Quality Likely Significant Effects of the Scheme [APP-330].	<p>NCC agrees with the use of HA207/07 and the supporting Interim Advice Notes (IANs) to inform the air quality assessment in Chapter 5 of the ES Part A and Part B [APP-040 and APP-041] as well as in the assessment of cumulative air quality impacts [APP-330].</p> <p>NCC supports the use of the emission rates issued by Highways England in line with IAN185/15 (derived from version 8 of Defra's Emission Factor Toolkit) and supporting tools including background mapping with a reference monitoring year of 2015 (the Scheme baseline year) and version 6.1 of the Nox-to-NO2 calculator issued by Defra in line with version 8 of the Emission Factor Toolkit.</p>	Agreed	Agreed
3.2	Appendix 5.8 – Air Quality DMRB Sensitivity Test Part A and B [APP-205] and [APP-275]	<p>NCC supports the need for the DMRB Sensitivity [APP-] Test to resolve any changes arising from the difference in approach as a result of the issue of DMRB document LA105, which supersedes the HA207/07 guidance and supporting IANs.</p> <p>NCC also supports the need for the Air Quality Updated Assessment (Scheme Opening Year 2024) [REP3-010] to capture any changes in the impact of the Scheme with the revised Scheme opening year (from 2023 to 2024). Furthermore, NCC accepts that this Updated Assessment should follow the guidance set out in DMRB document LA105 as this provides the most appropriate up-to-date available guidance.</p> <p>NCC supports the use of the latest emission rates (issued by Highways England in line with LA105 and derived from version 10 of Defra's Emission Factor Toolkit) and supporting tools (including background mapping from 2015 and version 8.1 of the Nox-to-NO2 calculator issued by Defra in line with version 10 of the Emission Factor Toolkit) within the Updated Assessment.</p>	Agreed	Agreed

Item	Document	NCC Position	Highways England Response	Status
		NCC agrees that the approach undertaken in the Updated Sensitivity Test is appropriate, and that the difference in the Scheme's impact on human health between 2023 and 2024 have been captured within the Updated Sensitivity Test.		
3.3	Air Quality Updated Assessment (Scheme Opening Year 2024) [REP3-010]	NCC agrees that appropriate and adequate baseline data have been used within the baseline assessment of the Scheme set out in Chapter 5 of the ES Part A and Part B [APP-040 and APP-041]. NCC confirms that the diffusion tube monitoring undertaken for the Scheme offers appropriate coverage of the areas of concern highlighted by NCC, and furthermore offers sufficient coverage of the air quality study area for the Scheme.	Agreed	Agreed
3.4	Chapter 5 of the ES Part A and Part B [APP-040 and APP-041] and Appendix 16.4 Air Quality Likely Significant Effects of the Scheme [APP-330].	NCC's Public Health Protection Unit are satisfied that the selection of receptors includes those identified by NCC, and that the assessment considers those nearest receptors which are representative of the worst-case impacts of the Scheme and areas of existing poor air quality. Furthermore, the receptors offer sufficient coverage of the air quality study area for the Scheme.	Agreed	Agreed
3.5	Chapter 5 of the ES Part A and Part B [APP-040 and APP-041]	NCC agrees with the findings and conclusions of the assessment set out in Chapter 5 of the ES Part A and Part B [APP-040 and APP-041], the Cumulative Assessment [APP-330] and the Updated Air Quality Assessment (Scheme Opening Year 2024) [REP3-010]. In all cases there were no significant air quality effects relating to human health, compliance with air quality limit values, or statutory nuisance identified.	Agreed	Agreed
3.6	Appendix 16.4 Air Quality Likely Significant Effects of the Scheme [APP-330].	NCC agrees that no mitigations measures to deduce the impacts of the Scheme on Air Quality are required during the operational phase of the Scheme.	Agreed	Agreed
3.7	Chapter 5 of the ES Part A and Part B [APP-040 and APP-041]	NCC's Public Health Protection Unit considers that the proposed dualling will improve the overall flow of traffic on the entire section of dual-carriageway from Fairmoor to Ellingham and specifically along the two existing single-carriageways that form Part A and Part B. This will improve emissions from the majority of smaller vehicles whose speed limit is often constrained by slower moving HGV traffic.	Agreed	Agreed
3.8	Appendix 16.4 Air Quality Likely Significant Effects of the Scheme [APP-330]	NCC agrees that dust from demolition / construction works can be managed and mitigated and compliance with a dust management plan would be the controlling mechanism during development. NCC agrees that the outline measures proposed in Chapter 5 of the ES Part A and Part B [APP-040 and APP-041] and the Outline Construction Environmental Management Plan	Agreed	Agreed

Item	Document	NCC Position	Highways England Response	Status
		(CEMP) [REP3-014] are appropriate to control the impacts of the Scheme on air quality during the construction phase. Agreement on the measures to be included within the finalised CEMP will be required prior to construction commencing.		
4.	Noise and Vibration (including construction and operational)			
4.1	Chapter 6 Noise and Vibration Part A [APP-042], Section 6.3, Paragraphs 6.3.1 to 6.3.22 Chapter 6 Noise and Vibration Part B [APP-043], Section 6.3, Paragraphs 6.3.1 to 6.3.22	It is agreed that, for the construction stage of the Scheme, the relevant legislative and policy framework for noise and vibration is set out within Chapter 6: Noise and Vibration Part A [APP-042], Section 6.3, Paragraphs 6.3.1 to 6.3.22, and Chapter 6: Noise and Vibration Part B [APP-043], Section 6.3, Paragraphs 6.3.1 to 6.3.22 along with an appropriate appraisal of compliance of the Scheme against each relevant policy objective. It is agreed that the assessments presented within Chapter 6: Noise and Vibration Part A [APP-042] and Chapter 6: Noise and Vibration Part B [APP-043] appropriately consider and apply the relevant legislation and policy to the construction stage of the Scheme in relation to noise and vibration.	Agreed	Agreed
4.2	Noise Addendum – Rev 0 [REP1-019], Section 1.6, Paragraphs 1.6.1 to 1.6.16	For the operational stage of the Scheme, the relevant legislative and policy framework for noise and vibration is set out within Noise Addendum – Rev 0 [REP1-019], Section 1.6, Paragraphs 1.6.1 to 1.6.16 along with an appropriate appraisal of compliance of the Scheme against each relevant policy objective. It is agreed that the assessment presented within Noise Addendum [REP1-019] appropriately considers and applies the relevant legislation and policy to the operational stage of the scheme in relation to noise.	Agreed	Agreed
4.3	Chapter 6 Noise and Vibration Part A [APP-042], Section 6.4 Chapter 6 Noise and Vibration Part B [APP-043], Section 6.4	The detailed methodology applicable to the construction stage noise and vibration assessments is presented within Chapter 6 Noise and Vibration Part A [APP-042], Section 6.4 and Chapter 6 Noise and Vibration Part B [APP-043], Section 6.4. It is agreed that the scope and methodology adopted and applied for the assessment of potential construction stage noise and vibration impacts is appropriate.	Agreed	Agreed

Item	Document	NCC Position	Highways England Response	Status
4.4	Noise Addendum – Rev 0 [REP1-019], Section 1.7, Paragraphs 1.7.1 to 1.7.36	<p>The detailed methodology applicable to the operational stage noise assessment is presented within Noise Addendum – Rev 0 [REP1-019], Section 1.7, Paragraphs 1.7.1 to 1.7.36.</p> <p>It is agreed that the scope and methodology adopted and applied for the assessment of potential operational stage noise and vibration impacts is appropriate.</p>	Agreed	Agreed
4.5	<p>Chapter 6 Noise and Vibration Part A [APP-042], Section 6.5, paragraphs 6.5.1 to 6.5.11</p> <p>Chapter 6 Noise and Vibration Part B [APP-043], Section 6.5, paragraphs 6.5.1 to 6.5.11.</p>	<p>Assessment assumptions and limitations applicable to the construction stage noise and vibration stage assessments are set out within Chapter 6: Noise and Vibration Part A [APP-042], Section 6.5, paragraphs 6.5.1 to 6.5.11 and Chapter 6: Noise and Vibration Part B [APP-043], Section 6.5, paragraphs 6.5.1 to 6.5.11.</p> <p>It is agreed that the presented assumptions and limitations are appropriate for the stage of noise and vibration assessment and have been suitably considered.</p>	Agreed	Agreed
		<p>NCC additional comment – It is appreciated that the exact composition of plant and equipment will be unknown until the main contractor is appointed. Whilst it is appreciated that a “worst case scenario” is presented, any such assessment should be reviewed once the exact composition of plant and equipment is known and compared to the one presented at this stage, to address any impacts above the current predictions.</p>	Applicant's response – It is expected that such an assessment will be undertaken at detailed design stage as part of the application under Section 61 of Part III of the Control of Pollution Act 1974 (See Outline Construction Environmental Management Plan [REP3-013 (Ref S-G9 and S-N2 point j)]).	Agreed
4.6	Noise Addendum – Rev 0 [REP1-019], Section 1.8, Paragraphs 1.8.1 to 1.8.8	<p>Assessment assumptions and limitations applicable to the operational stage noise assessment are set out within Noise Addendum – Rev 0 [REP1-019], Section 1.8, Paragraphs 1.8.1 to 1.8.8.</p> <p>It is agreed that the presented assumptions and limitations are appropriate for the stage of noise assessment and have been suitably considered.</p>	Agreed	Agreed
4.7	<p>Chapter 6 Noise and Vibration Part A [APP-042], Section 6.6, paragraphs 6.6.1 to 6.6.4.</p> <p>Chapter 6 Noise and Vibration Part B [APP-043], Section 6.6, paragraphs 6.6.1 to 6.6.3.</p>	<p>The Study Areas relevant to the construction stage noise and vibration assessment are set out within Chapter 6: Noise and Vibration Part A [APP-042], Section 6.6, Paragraph 6.6.1 to 6.6.4 and Chapter 6: Noise and Vibration Part B [APP-043], Section 6.6, Paragraph 6.6.1 to 6.6.3.</p> <p>It is agreed that the Study Areas have been appropriately defined based on available guidance and professional judgement and are sufficient to enable the potential impacts of the construction stage of the Scheme to be identified.</p>	Agreed	Agreed
		<p>The Public Health Protection Unit are confident that a comprehensive CEMP as proposed by the Applicant should be sufficient to manage and control construction noise providing</p>	The Applicant agrees that a CEMP, included in Requirement 4 of the draft DCO [REP5-00534 and 035],	Agreed

Item	Document	NCC Position	Highways England Response	Status
		that this is communicated to all contractors and sub-contractors whose work has the potential to generate noise.	is an appropriate means of managing noise during the construction phase of the Scheme. The Applicant also confirms that all contractors and sub-contractors will be made aware of the requirements of the CEMP.	
4.8	Noise Addendum – Rev 0 [REP1-019], Section 1.9, Paragraphs 1.9.1 to 1.9.8	<p>The operational road traffic noise Study Area is set out within Noise Addendum [REP1-019], Section 1.9, Paragraphs 1.9.1 to 1.9.8.</p> <p>It is agreed that the Study Area has been appropriately defined based on available guidance and is sufficient to enable the potential impacts of the operational phase of the Scheme to be identified</p>	Agreed	Agreed
4.9	<p>Chapter 6 Noise and Vibration Part A [APP-042], Section 6.7*</p> <p>Chapter 6 Noise and Vibration Part B [APP-043], Section 6.7*</p>	<p>Baseline conditions applicable to the construction stage noise and vibration assessments are presented within Chapter 6 Noise and Vibration Part A [APP-042], Section 6.7, and Chapter 6 Noise and Vibration Part B [APP-043], Section 6.7. *</p> <p>It is agreed that the description of baseline conditions, details of sensitive receptors, and noise survey results are an accurate reflection of the existing baseline environment and are appropriate for the purpose of the construction phase assessments.</p>	Agreed	Agreed
4.10	<p>Noise Addendum – Rev 0 [REP1-019], Section 1.10, Paragraphs 1.10.1 to 1.10.29</p> <p>Chapter 6 Noise and Vibration Part A [APP-042], Section 6.7*</p> <p>Chapter 6 Noise and Vibration Part B [APP-043], Section 6.7*</p>	<p>Baseline conditions applicable to the operational phase noise and vibration assessment are presented within deadline 1 submission – 6.22 Noise Addendum [REP1-019] paragraphs 1.10.1 to 1.10.29, Chapter 6: Noise and Vibration Part A [APP-042], Section 6.7, and Chapter 6 Noise and Vibration Part B [APP-043], Section 6.7. *</p> <p>It is agreed that the description of baseline conditions, details of sensitive receptors, and noise survey results are an accurate reflection of the existing baseline environment and are appropriate for the purpose of the operational phase assessment.</p> <p>It is agreed that the appraisal of future baseline conditions presented within the deadline 1 submission – 6.22 Noise Addendum [REP1-019], paragraph 1.10.15 to 1.10.29, is appropriate and accurate based on provided traffic data.</p>	Agreed	Agreed
		The Applicant has indicated that traffic data supporting the application has been reviewed to the satisfaction of Northumberland County Council Highways. This is acceptable and no further comments are to be made on this point.	Agreed	Agreed
4.11	Chapter 6 Noise and Vibration Part A	Potential impacts applicable to the construction stage noise and vibration assessment are predicted and assessed within Chapter 6 Noise and Vibration Part A [APP-042], Section	Agreed	Agreed

Item	Document	NCC Position	Highways England Response	Status
	[APP-042], Section 6.8, paragraphs 6.8.1 to 6.8.32 Chapter 6 Noise and Vibration Part B [APP-043], Section 6.8, paragraphs 6.8.1 to 6.8.38	6.8, paragraphs 6.8.1 to 6.8.32 and Chapter 6 Noise and Vibration Part B [APP-043], Section 6.8, paragraphs 6.8.1 to 6.8.38. It is agreed that the potential noise and vibration impacts have been appropriately assessed implementing suitable methodologies with consideration given to compliance against relevant planning policies. It is agreed that potential noise and vibration impacts of the Scheme in relation to noise and vibration sensitive receptors have been accurately documented.		
		NCC additional comment – However, the Public Health Protection Unit cannot confirm compliance with planning policies – this would be within the scope of the Local Planning Authority.	Noted. The Scheme is assessed against planning policy contained in Part 1 of this Table. No conflicts with planning policy in relation to noise have been raised by NCC.	Agreed
4.12	Noise Addendum – Rev 0 [REP1-019], Section 1.11, Paragraphs 1.11.1 to 1.11.50	Potential impacts applicable to the operational stage noise assessment are predicted and assessed within Noise Addendum [REP1-019], Section 1.11, Paragraphs 1.11.1 to 1.11.50. It is agreed that the potential noise and vibration impacts have been appropriately assessed implementing suitable methodologies with consideration given to compliance against relevant planning policies. It is agreed that potential noise impacts of the Scheme in relation to all noise sensitive receptors have been accurately documented.	Agreed	Agreed
		NCC additional comment – However, the Public Health Protection Unit cannot confirm compliance with planning policies – this would be within the scope of the Local Planning Authority.	Noted. The Scheme is assessed against planning policy contained in Part 1 of this Table. No conflicts with planning policy in relation to noise have been raised by NCC.	Agreed
4.13	Chapter 6 Noise and Vibration Part A [APP-042], Section 6.9* Chapter 6 Noise and Vibration Part B [APP-043], Section 6.9*	Proposed construction noise and vibration mitigation is presented within Chapter 6 Noise and Vibration Part A [APP-042], Section 6.9 and Chapter 6 Noise and Vibration Part B [APP-043], Section 6.9 * It is agreed that the construction noise and vibration mitigation measures detailed are appropriate.	Agreed	Agreed

Item	Document	NCC Position	Highways England Response	Status
4.14	Noise Addendum – Rev 0 [REP1-019], Section 1.12, Paragraphs 1.12.1 to 1.12.35	<p>It is agreed that noise and vibration design, mitigation and enhancement measures have been appropriately considered for the operational stage of the scheme within Noise Addendum [REP1-019], Section 1.12, Paragraphs 1.12.1 to 1.12.35.</p> <p>It is agreed that the operational noise design, mitigation and enhancement measures detailed are appropriate.</p>	Agreed	Agreed
4.15	<p>Chapter 6 Noise and Vibration Part A [APP-042], Section 6.10, paragraphs 6.10.1 to 6.10.6.</p> <p>Chapter 6 Noise and Vibration Part B [APP-043], Section 6.10, Paragraph 6.10.1 to 6.10.4.</p>	<p>Assessment of likely significant construction stage noise and vibration effects is presented within Chapter 6: Noise and Vibration Part A [APP-042], Section 6.10, paragraphs 6.10.1 to 6.10.6 and Chapter 6: Noise and Vibration Part B [APP-043], Section 6.10, Paragraph 6.10.1 to 6.10.4.</p> <p>It is agreed that the assessment of likely significant construction stage effects is proportionate to the impacts of the Scheme following implementation of the proposed mitigation.</p>	Agreed	Agreed
4.16	Noise Addendum – Rev 0 [REP1-019], Section 1.13, Paragraphs 1.13.1 to 1.13.24	<p>Assessment of likely significant operational stage noise effects is presented within Noise Addendum – Rev 0 [REP1-019], Section 1.13, Paragraphs 1.13.1 to 1.13.24.</p> <p>It is agreed that the assessment of likely significant operational stage noise and vibration effects considers the predicted impacts of the Scheme following implementation of the proposed mitigation.</p>	Agreed	Agreed
4.17	Noise Addendum – Rev 0 [REP1-019], Section 1.14, Paragraph 1.14.1 and Tables 1.41 and 1.42.	It is agreed that the assessment parameters applicable to the operational stage of the Scheme in relation to noise are appropriately considered within Noise Addendum [REP1-019], Section 1.14, Paragraph 1.14.1 and Tables 1.41 and 1.42.	Agreed	Agreed
4.18	Noise Addendum – Rev 0 [REP1-019], Section 1.15, Paragraph 1.15.1 to 1.15.9.	It is agreed that the Scheme carriageway alignment limits of deviation have been appropriately considered within Noise Addendum [REP1-019], Section 1.15, Paragraph 1.15.1 to 1.15.9.	Agreed	Agreed
		NCC is aware that the Applicant has confirmed that should it be considered necessary for design to deviate from the proposed Scheme 3D General Arrangement within the Limits of Deviation, the earthworks and proposed noise barriers associated with the Scheme would be re-considered by the main contractor to ensure that no greater or different	Agreed	Agreed

Item	Document	NCC Position	Highways England Response	Status
		significant adverse effects would arise. On the basis of this clarification, NCC has no further comments to make.		
4.19	Chapter 6 Noise and Vibration Part A [APP-042], Section 6.11, paragraph 6.11.1. Chapter 6 Noise and Vibration Part B [APP-043], Section 6.11, Paragraph 6.11.1.	It is agreed that the requirement for noise or vibration monitoring during the construction phase will be determined once a detailed programme of works and schedule of plant has been produced by the contractor.	Agreed	Agreed
4.20	Noise Addendum – Rev 0 [REP1-019], Section 1.16, Paragraph 1.16.1.	Based on the Scheme as assessed within Noise Addendum [REP1-019] it is agreed that no noise or vibration monitoring will be required for the operation of the Scheme once it is completed.	Agreed	Agreed
* Chapter 6 Part A and B section and paragraph references exclude paragraphs and tables listed within Deadline 1 submission 6.22 Noise Addendum [REP1-019] Table 1-1 which have been replaced by the Noise Addendum.				
5. Landscape and visual impact				
5.1	Chapter 7 (Landscape and Visual) of the ES [APP044 and APP045]	25/01/2021 – It is agreed that the study area is appropriate for the Proposed Scheme (Parts A and B).		Agreed

Item	Document	NCC Position	Highways England Response	Status
5.2	Chapter 7 (Landscape and Visual) of the ES [APP044 and APP045] Chapter 7 (Landscape and Visual) of the ES [APP044 and APP045]	It was not agreed that the methodology used (based on Highways England's IAN 135/10) was fully up to date and appropriate, despite this, it is agreed that the findings of the LVIAs are robust. NCC's remaining concerns were focused on the visual effects on communities, users of the B6341 and character areas (which arose in part from the methodology used) and are now addressed as set out below in items 5.5, 5.7 and 5.8. NCC's concerns focussing on the visual effects on communities, users of the B6341 and character areas (which arose in part from the methodology used) are now addressed as set out below under items 5.5, 5.7 and 5.8,	The assessment of landscape effects has been undertaken in accordance with then-current best practice as set out in IAN 135/10. Following the issue of updated guidance, a sensitivity test has been undertaken, which demonstrates that the original assessments appropriately predict landscape impacts. The Applicant acknowledges agreement on the findings of the LVIA. The Applicant has addressed more specific comments on the local impacts that NCC feel have not been adequately identified below in items 5.5, 5.7 and 5.8. The Applicant acknowledges NCC's remaining concerns which it is agreed have been addressed below under items 5.5, 5.7 and 5.8.	Agreed
5.3	Chapter 7 (Landscape and Visual) of the ES [APP044 and APP045]	It is agreed that the scope of landscape character assessment for both LVIAs is adequate to address all significant effects.		Agreed
5.4	Chapter 7 (Landscape and Visual) of the ES [APP044 and APP045]	It is agreed that the variation on judgements regarding the landscape sensitivity, set out within the LIR are minor and do not contribute markedly to the disagreement regarding the significance of effect.		Agreed
5.5	Chapter 7 (Landscape and Visual) of the ES [APP044 and APP045]	Effects on character areas are as identified within the LVIAs with the exception of character areas 38b (Part A), 3c and 8c (Part B), where NCC set out within the LIR their judgment that some local impacts would be greater in magnitude and significance than the effects identified within the LVIAs, which contextualise those effects within the wider character areas. However, the provision of updated Landscape Mitigation Plans for Part A means that NCC are able to revise their assessment for effects on character area 38b at Year 15 and now consider effects to be of Slight magnitude and Moderate/Minor significance. This remains greater than the Negligible magnitude and Slight Adverse effects identified in the LVIA, but it is agreed that effects would not be significant. All other effects on landscape character are agreed with the exception of Year 1 (early completion) effects on character areas 3c and 8c (both affected by part B) where NCC and the Applicant differ on the degree to which the loss of vegetation and (as yet unmitigated) presence of a wider road and new overbridge would affect the character.	The Applicant acknowledges the agreement with the effects on landscape character, with the exception of character areas 38b (Part A), 3c and 8c (Part B). The Applicant has reviewed the LIR [REP1-071] and concluded that the effects on character areas are agreed, with the exception of LCA 38b Longhorsley, which is considered by NCC to have significant effects extending beyond the summer of year 15, and LCA 8c Charlton Ridge that NCC considers would be subject to slightly greater effects following construction, but would, in the summer of year 15 be subject to a neutral effects, as reported by the Applicant. A full response to this position is provided in the Applicant's response to LIR at Deadline 3 (document reference 7.16). The Applicant acknowledges the findings of the assessment of effects on landscape character as set	Agreed

Item	Document	NCC Position	Highways England Response	Status
		NCC judge that effects during this stage would be of a similar magnitude and significance to those during construction, whilst the Applicant judges that these effects would be of a similar magnitude and significance to those of the design year.	out in the LIR [REP1-071] and agrees that whilst there remains a difference of opinion on the findings, these are minor and do not materially change the overall findings of the LVIA, as set out in Chapter 7: Landscape and Visual Part A [APP-044].	
5.6	Chapter 7 (Landscape and Visual) of the ES [APP044 and APP045]	It is agreed that the scope of the visual impact assessment for both LVIAs is adequate to address all significant effects, with the exception of the potential effects on communities.	The Applicant acknowledges agreement on the scope of the visual effect's assessment for Parts A and B, with the exception of the potential effects on communities which are addressed in 5.7 below.	Agreed
5.7	Chapter 7 (Landscape and Visual) of the ES [APP044 and APP045]	<p>There has been an ongoing discussion between the Applicant and NCC over the visual effects of the Scheme on communities at Fenrother, Causey Park Bridge, Causey Park and West Moor.</p> <p>Following proposed changes to mitigation proposals contained in Landscape Mitigation Masterplan Part A (change request) [REP4-060], and further discussion over the assessment of visual effects on the communities at Fenrother, Causey Park, Causey Park Bridge and West Moor, the effects on these communities are agreed to be as set out within the Part A LVIA, modified only by the clarifications agreed regarding viewpoints 31 and 36 below in item 5.9.</p>	The Applicant acknowledges resolution on the concerns raised by NCC in reference to the effects on communities, and agreement on the findings of the effects as set out in Chapter 7: Landscape and Visual Part A [APP-044]. Specific concerns relating to viewpoints 31 and 36 have been agreed below in item 5.9.	Agreed
5.8	Chapter 7 (Landscape and Visual) of the ES [APP044 and APP045]	<p>The visual effects on users of B6341 (both day and night) have been the subject of an ongoing discussion between NCC and the Applicant.</p> <p>The Applicant's response to LIR at Deadline 3 (document reference 7.16) clarified the nature of hedgerow planting proposed and provided an assessment of effects on the B6341 and have resolved NCC concerns regarding effects on the users of the B6341.</p> <p>Whilst the precise details of effects on different stretches of the route are not entirely agreed, these differences are minor and both parties identify some significant effects during construction and Year 1. With the nature of the planting now clarified, there is also agreement that that effects would not be significant at Year 15.</p> <p>There are also minor differences of opinion regarding effects on users of the B6341 at night, arising from views of car headlights moving along the A1 during early competition (Year 1). However, it is agreed that effects would not be significant.</p>	<p>The Applicant acknowledges NCC's confirmation that the effects on the B6341 have been provided, and whilst there remains some disagreement on the effects on some specific stretches during construction and Year 1, the additional information relating to the long term management of the hedgerows means that there is agreement on the non-significant effects on users of the B6341 in Year 15.</p> <p>The Applicant acknowledges that the effects on users of the B6341 at night and prior to the establishment of the roadside planting are not entirely agreed upon, however, it is agreed that the effects in year 15 would not be significant.</p>	Agreed
5.9	Chapter 7 (Landscape and Visual) of the ES	<p>The visual effects on the viewpoints (Part A) provide sufficient information and in the most part is agreed to be as set out within the LVIA, other than viewpoints 6, 31 and 36.</p> <p>These viewpoints were discussed as follows:</p>	The Applicant acknowledges agreement on the visual effects on the viewpoints (Part A), with the exception of viewpoints 6, 31 and 36 which are not agreed.	Agreed

Item	Document	NCC Position	Highways England Response	Status															
	[APP044 and APP045]	<p>Viewpoint 6 – NCCs concerns regarding the visual effects arising from the removal of Coronation Avenue have been addressed via the submission of revised Landscape Mitigation plans (ref). As a result, there is now agreement that visual effects at year 15 would not be significant, although NCC remain of the opinion that effects at year 1 and year 15 would be greater than indicated in the LVIA – as indicated below:</p> <table border="1"> <tr> <td></td><td>Year 1 Mag.</td><td>Year 1 Sig.</td><td>Year 15 Mag.</td><td>Year 15 Sig.</td></tr> <tr> <td>LVIA</td><td>Minor</td><td>Moderate</td><td>Negligible</td><td>Slight</td></tr> <tr> <td>NCC</td><td>Moderate</td><td>Large</td><td>Minor</td><td>Moderate</td></tr> </table> <p>Viewpoints 31 and 36 – NCCs concerns regarding the disparity between assessed effects for the nearest houses and the effects on nearby residents identified for these two viewpoints have been addressed in Deadline 3 submissions (at 6.5.24 of [Rep3-025]). It is agreed that effects for the nearest residents, that form part of the community in the immediate vicinity of these viewpoints would be as set out within the LVIA for the nearest residential receptors and would therefore be significant. The visual receptors that form the remainder of the communities associated with these viewpoints would not be subject to a significant effect</p>		Year 1 Mag.	Year 1 Sig.	Year 15 Mag.	Year 15 Sig.	LVIA	Minor	Moderate	Negligible	Slight	NCC	Moderate	Large	Minor	Moderate	<p>The position in relation to these viewpoints is as follows:</p> <p>Viewpoint 6 – The Applicant considers that in providing more information as to the number and location of the tree replacement strategy for the Coronation Avenue, the effects on the receptors associated with Viewpoint 6 in year 15 are slight adverse. The Applicant is in agreement with NCC that for viewpoint 6 the effects would not be significant, nevertheless the Applicant acknowledges NCC's opinion that there is a minor discrepancy between the findings.</p> <p>Viewpoints 31 and 36 – These viewpoints are representative of broader clusters of receptors, within which some receptors have been assessed as being subject to a greater significance of effects that is reported for the viewpoint.</p> <p>In relation to viewpoints 31 and 36, the Applicant acknowledges NCC's agreement on the findings of the assessment, which for the closest receptors would be significant, but that for the remainder of the receptors associated with these receptors the effect would not be significant.</p>	
	Year 1 Mag.	Year 1 Sig.	Year 15 Mag.	Year 15 Sig.															
LVIA	Minor	Moderate	Negligible	Slight															
NCC	Moderate	Large	Minor	Moderate															
5.10	Chapter 7 (Landscape and Visual) of the ES [APP044 and APP045]	The night-time effects of Part A are agreed.		Agreed															
5.11	Chapter 7 (Landscape and Visual) of the ES [APP044 and APP045]	There are minor differences of opinion between the Applicant and NCC remaining regarding effects on users of the B6341 at night, arising from views of car headlights moving along the A1 during early competition (Year 1). However, it is agreed that effects would not be significant.	<p>The Applicant considers that had an assessment of the effects on night-time users of the B6341 been undertaken, the conclusion of the assessment would be that significant effects would not arise, which reflects the findings of NCC's assessment as set out within the LIR [REP1-071]</p> <p>A full response to this position is provided in the Applicant's response to LIR at Deadline 3 (document reference 7.16).</p> <p>Overall, the Applicant acknowledges that the effects on users of the B6341 at night and prior to the establishment of the roadside planting are not entirely agreed upon, however, it is agreed that the effects would not be significant.</p>	Agreed															

Item	Document	NCC Position	Highways England Response	Status
5.12	Chapter 7 (Landscape and Visual) of the ES [APP044 and APP045]	Subject to the inclusion of the requirement for a LEMP, NCC are satisfied that the mitigation strategy provides sufficient information relating to species and future management, in order that significant effects are adequately mitigated.	The Applicant acknowledges NCC's agreement, and has included a specific item in the Outline CEMP (item S-L100 in Table 3.1 Register of Environmental Actions and commitments: The Scheme) in the Outline CEMP [REP3-013]	Agreed
5.13	Chapter 7 (Landscape and Visual) of the ES [APP044 and APP045]	The submissions at deadlines 1-3, improvements to mitigation proposals included in (ref mitigation plans), and further discussion have resolved NCC concerns about the assessment of visual effects on the communities at Fenrother, Causey Park, Causey Park Bridge and West Moor.	Following discussions with NCC, the Applicant has updated Landscape Mitigation Masterplan Part A (change request) [REP4-060] and this is agreed with NCC. The Applicant acknowledges resolution on the concerns raised by NCC in reference to the effects on communities, and agreement on the findings of the effects as set out in Chapter 7: Landscape and Visual Part A [APP-044].	Agreed
5.14	Chapter 7 (Landscape and Visual) of the ES [APP044 and APP045]	It is agreed that following submission of the Coronation Avenue Replacement Strategy (DRAFT) at Deadline 1, that the number and location of replacement trees are appropriate.		Agreed
5.15	Chapter 7 (Landscape and Visual) of the ES [APP044 and APP045]	Following inclusion within the Outline CEMP of item ExA S-L100 that secures the preparation of a LEMP, subject to consultation with NCC under Requirement 5 of the draft DCO, provides a structure for this document and identifies reference documents for its drafting, NCC are satisfied that the mitigation strategy, and its long term management is sufficiently secured and robust to mitigate the Scheme.	The Applicant acknowledges NCC's confirmation that the preparation of a LEMP is sufficiently secured to ensure the delivery of the proposed mitigation strategy and long-term management.	Agreed
5.16	Chapter 7 (Landscape and Visual) of the ES [APP044 and APP045]	Taking account of improvements to mitigation measures for Part A and clarifications regarding mitigation measure for part B as submitted at Deadlines 1-3, it is now agreed that all proposed landscape and visual mitigation measures are appropriate and adequate.	The Applicant acknowledges agreement that all proposed landscape and visual mitigation measures are appropriate and adequate.	Agreed
6	Historic Environment			
6.1	Chapter 8 (Cultural Heritage) of the ES [APP046 and APP047]	This refers to the Scheme as originally submitted (and Deadline 3). No comments yet provided in relation to the proposed scheme amendments that will be presented in ES Addendums.		Agreed

Item	Document	NCC Position	Highways England Response	Status
6.2	Chapter 8 (Cultural Heritage) Part A – Paragraph 8.3.1 to 8.3.8 of the ES [APP 046] and Part B Paragraph 8.3.1 to 8.3.8 [APP047]	It is agreed that the assessments presented within Chapter 8 appropriately considers relevant legislation and policy in relation to the historic environment.		Agreed
6.3	Chapter 8 (Cultural Heritage) Part A – Paragraph 8.4.1 to 8.4.41 of the ES [APP 046] and Part B Paragraph 8.4.1 to 8.4.34 [APP047]	<p>It is agreed that the scope and methodology adopted for the baseline cultural heritage assessment of the potential impacts is appropriate and follows standards and guidance.</p> <p>It is agreed that as the permanent easement along an existing track which passes Felton Park and through Parkwood subway in Part A would not be in used in the construction and during operation would only be utilised occasionally to monitor and provide maintenance to the subway and a buried geocellular drainage tank, there would be no change on the setting of the designated assets situated alongside it (one Grade II* Listed Building (NHL 1154561), and four Grade II Listed (NHL 1371126, 1303774, 1041874 and 1303719)) and therefore this would not be considered in the assessment.</p>		Agreed
6.4	Chapter 8 (Cultural Heritage) Part A – Paragraph 8.5.1 to 8.5.10 of the ES [APP 046] and Part B Paragraph 8.5.1 to 8.5.6 [APP047]	It is agreed that the assumptions and limitations to the historic environment assessment have been acknowledged and appropriately considered within the assessment.		Agreed
6.5	Chapter 8 (Cultural Heritage) Part A – Paragraph 8.6.1 to 8.6.3 of the ES [APP 046] and Part B Paragraph 8.6.1 to 8.6.3 [APP047]	<p>It is agreed that the inner Study Area of 500 m is appropriate for the identification of all types of heritage assets (designated, non-designated, potential archaeological remains and historic landscapes) to establish the known historic environment context and potential for hitherto unknown below-ground archaeological remains.</p> <p>It is agreed that the outer Study Area of 1km for the assessment of setting heritage assets and Conservation Areas is appropriate.</p> <p>It is agreed that the extension of the outer Study Area for Part B to include Grade I Registered Park and Garden Alnwick Castle (NHL 10014041) and all designated heritage assets located within it.</p>		Agreed
6.6	Chapter 8 (Cultural Heritage) Part A – Paragraph 8.7.1 to 8.7.61 of the ES [APP 046] and Part B Paragraph 8.7.1 to 8.7.87 [APP047]	It is agreed that the heritage assets identified and described in the baseline are appropriate for the assessment. The baseline was based on desk-based assessment and supported by geophysical surveys, an assessment of LiDAR data and targeted trial trenching in areas where high value heritage assets were predicted to be present. The value of the heritage assets and the contribution of the setting to the value of the heritage asset (where appropriate) is correctly assessed.		Agreed

Item	Document	NCC Position	Highways England Response	Status
6.7	Chapter 8 (Cultural Heritage) Part A – Paragraph 8.8.1 to 8.8.4 of the ES [APP 046] and Part B Paragraph 8.8.1 to 8.8.4 [APP047]	<p>It is agreed that the receptors/heritage assets scoped out for assessment is appropriate for the assessment.</p> <p>It is agreed that the construction phase of Part A would not result in direct physical impacts on five Grade II Listed Buildings (NHL 1371039, 1371021, 1370646, 1303996 and 1042132) and the non-designated site of the Building at Tile Kiln Rush (HER 17065) and Priest Bridge (HER17397). It is agreed that operation phase Part A would not impact on the setting of six Grade II Listed mileposts (NHL 1153544, 1371039, 1371021, 1370646, 1303996, and 1042132).</p> <p>It is agreed that the construction and operation of Part B would not impact on the Grade I Registered Park and Garden Alnwick Castle (NHL 1001041) and all designated heritage assets located within it, and Rock Conservation Area.</p> <p>It is agreed that the potential impacts on heritage assets (including their setting) during construction and operation identified are adequately assessed. The assessment work has included targeted trial trenching by the Scheduled Monuments and has established that there is a low potential for high value assets associated with the Scheduled Monuments to be present within the Order limits.</p>		Agreed
6.8	Chapter 8 (Cultural Heritage) Part A – Paragraph 8.8.5 to 8.8.34 of the ES [APP 046] and Part B Paragraph 8.8.5 to 8.8.78 [APP047]	<p>It is agreed that the potential impacts on heritage assets (including their setting) during construction and operation identified are adequately assessed.</p> <p>The assessment work has included targeted trial trenching in Part B adjacent to Scheduled Monuments and has established that there is a low potential for high value assets associated with the Scheduled Monuments to be present within the Order limits.</p>		Agreed
6.9	Chapter 8 (Cultural Heritage) Part A – Paragraph 8.9.1 to 8.9.11 of the ES [APP 046] and Part B Paragraph 8.9.1 to 8.9.41 [APP047]	<p>It is agreed that the design and mitigation measures presented for heritage assets during construction and operation are appropriate.</p> <p>Design measures proposed as part of the surface water drainage system on Parts A and Parts B would remove impacts on below ground remains resulting from a change in hydrology. These are detailed in the Outline CEMP [REP1-023 and 024].</p> <p>The WSIs outline the approach to post development consent excavation assessment, reporting, dissemination of the results of the work and archiving. The WSIs have been produced in consultation with the NCC County Archaeologist. The WSIs include a requirement for the production of detailed method statements, which would supersede the draft WSIs, as the scheme progresses. The aim of the evaluation would be to determine the value, extent, date, level of survival of the assets, and to inform a mitigation strategy which would be implemented either prior to or during the construction stage. Any mitigation required would require the production of additional Written Schemes of Investigation in consultation with the NCC County Archaeologist. Where any below-ground archaeological remains are identified which require preservation in-situ, a detailed method statement would be required to set out how the remains would be protected during the construction stage. The method statement would be produced in consultation with NCC and potentially Historic England (depending on the nature of the assets) and could include measures such as avoidance through redesign, diversion (within the Order limits), or reburial and protection. The mitigation measures adopted would be dependent on the nature and material of heritage assets identified. This would be secured through the Outline CEMP [REP1-023 and 024]</p> <p>A programme of historic building recording would be undertaken post development consent and prior to the demolition of non-designated Charlton Mires Farm to ensure it is preserved by record. This is presented in the Draft WSI for Historic Building Recording (Appendix 8.6 [APP-296]) which has been approved by NCC.</p> <p>It is agreed that the no enhancement measures are required for the cultural heritage assessment.</p>		Agreed

Item	Document	NCC Position	Highways England Response	Status
6.10	Chapter 8 (Cultural Heritage) Part A – Paragraph 8.10.1 to 8.10.30 of the ES [APP 046] and Part B Paragraph 8.10.1 to 8.9.43 [APP047]	<p>It is agreed that the assessment of likely significant effects is appropriate for the cultural heritage assessment.</p> <p>It is agreed that the assessment of assessment parameters is appropriate for the cultural heritage assessment.</p> <p>It is agreed that the DMRB sensitivity test is appropriate for the cultural heritage assessment.</p>		Agreed
6.11	Chapter 8 (Cultural Heritage) Part A – Paragraph 8.11.1 of the ES [APP 046] and Part B Paragraph 8.11.1 [APP047]	It is agreed that the monitoring is appropriate and adequate in relation to cultural heritage.		Agreed
7.	Ecology, Habitats and Nature Conservation Effects			
7.1	Chapter 9 (Biodiversity) of the ES [APP048 and APP049]	NCC is satisfied that appropriate surveys have been carried out to assess the value of the habitat and the presence of any protected species. NCC is also content with the search / study areas used to assess the impacts of the Scheme.	Agreed	Agreed
7.2		Survey and mitigation for the protected species found along the route is also robust, and the provision of a number of animal crossing points for a range of species is welcome.	Agreed	Agreed
7.3		A number of UK and European Protected Species are present within the road corridor and may be impacted by the development but the approach to mitigation and licensing is sound.	Agreed	Agreed
7.4		The outline Construction Environmental Management Plan (CEMP) [REP1-023 and 024] includes all of the ecological mitigation requirements proposed and is comprehensive and robust, for this stage of the project. Further fine detail is required for works affecting watercourses including bridges, culverts and pollution prevention, although the detail provided so far is a good basis.	Agreed	Agreed
7.5		It is considered that the indicated proposed ecological mitigation identified in the CEMP reasonably considers construction and operational impacts of the project. However, some of the proposed mitigation will require time to establish and reach its full potential and this is why the Council considers the impacts on biodiversity overall to be a negative impact.	The Applicant agrees that the Scheme would result in adverse (negative impacts) but considers that the mitigation and compensation measures summarised within the Outline CEMP (as submitted at Deadline 10) are sufficient to avoid significant residual impacts, with the exception of those identified in section 9.10 of	Agreed

Item	Document	NCC Position	Highways England Response	Status
			Chapter 9: Biodiversity for Part A [APP-048] and Part B [APP-049].	
7.6		<p>The main document prepared by the Applicant to address impacts on ancient woodland is at Appendix 9.21: Ancient Woodland Strategy [APP-247].</p> <p>The overall design approach and the compensation package set out is in accordance with previous informal discussion with the County Ecologist who sought a 1:4 multiplier which is considered to be enhancement due to the significant increase in area of woodland created versus that which is lost.</p> <p>In this a suitable compensation strategy is in place. Whilst fine detail of that woodland creation is required (soil analysis of receptor site, translocation details of soils and young trees) the overall plan is welcomed. It includes the translocation of soils, saplings, ground flora seed, ancient woodland indicator species and felled timber (for deadwood habitat) from the ancient woodland site which will safeguard the seedbank present in that soil and improve the chances of success of replicating that habitat over time.</p> <p>The County Ecologist considers both the location and increased area of the new woodland (adjacent to the River Coquet) to be optimal.</p> <p>The need for this dualling of the A1 would be an exceptional circumstance, and the widening of an existing route would be the preferable option to a new route being created.</p>	Agreed	Agreed
7.7		Two years is a general requirement for the validity of survey reports, but it is often the case with large infrastructure projects that surveys may be out of date and require updating. In this case the habitats affected are not likely to have undergone significant change and a series of checking surveys are included within the mitigation and pre-start operations, which will be controlled by Construction Environmental Management Plan (CEMP).	Agreed	Agreed
7.8		Further discussions will be required in relation in relation to Ecology, habitats and nature conservation effects.	Agreed	Agreed
7.9		During ISH3, Northumberland County Council stated that they consider otter to be widespread in Northumberland and would usually assume presence of otter in their role as the local planning authority (applying a precautionary principle). As such, NCC do not agree with the conclusion of likely absence of otter for Part B. NCC would therefore welcome simple mitigation measures (such as barriers and improvement to culverts) for otter for Part B.	<p>The Applicant's conclusion of likely absence of otter for Part B was based on the identification of historic records (the most recent record returned from 2015 approximately 1km to the east of the A1 carriageway, the most recent otter casualty on the A1 within the Order limits of Part B dates back to 2011) and the absence of evidence of otter activity or presence recorded during field surveys undertaken between 2016 and 2019.</p> <p>Following ISH3, the Applicant held discussions with the Environment Agency on 23 and 30 April 2021 to explore the evidence for the presence of otter. During the meeting on 30 April 2021, the Environment Agency</p>	Agreed

Item	Document	NCC Position	Highways England Response	Status
			<p>provided recent evidence of otter adjacent to the study area for Part B at Shipperton Burn. The Applicant has re-evaluated the position in light of this new evidence and now accepts that otter are present within the Order limits of Part B. Accordingly, the Applicant has now proposed otter fencing at four locations along Part B (Shipperton Burn, Kittycarter Burn, White House Burn and Denwick Burn) to direct otter passage through culverts beneath Part B that are of a sufficient size to offer safe passage. The Applicant has discussed and agreed the proposed location and length of fencing with the Environment Agency and Northumberland County Council. The proposed fencing is captured and secured by Commitment ExA: B-B100 of the Outline CEMP [REP7-008 and 009] updated at Deadline 8 and presented on an updated Landscape Mitigation Masterplan Part B [REP6-018] submitted at Deadline 8.</p> <p>The Applicant has agreed with both the Environment Agency and Northumberland County Council that the proposed mitigation is sufficient to address their concerns regarding otter for Part B. As such, the assessment of, and proposed mitigation for, otter is agreed for the Scheme.</p>	
7.10		<p>At Deadline 6, Northumberland County Council provided a post-hearing note [REP6-050] that included the following statement about water vole for Part B:</p> <p><i>“Where present (noting some evidence in early surveys in the ES Appendix 9.3 at APP-300) water vole are under-reported in recent years, considered rare in the County, and where pre-construction updating surveys confirm presence suitable mitigation will be required. It is acceptable for this to be included in the Schedule of Requirements.”</i></p>	<p>A water vole survey undertaken in 2016 by the Applicant purported to have recorded potential water vole field signs along Part B. However, the field signs recorded were not conclusively attributed to water vole and field signs of mink were also recorded, indicating presence and activity of this species in the area. Presence of mink is a significant factor reducing the likelihood of water vole occurring. It is generally accepted that mink can eradicate a water vole population if present.</p> <p>Updated field surveys were undertaken in 2018 and 2019 and no evidence of water vole activity or presence was recorded. As detailed in Table 9-9 of Chapter 9: Biodiversity Part B [APP-049], water vole is considered likely absent from within Part B and Part B Survey Area.</p> <p>Requirement 7, Schedule 2 of the Draft DCO [REP5-034 and 035] states that <i>“following pre-construction survey work or at any time when carrying out the authorised development, a) a protected species is</i></p>	Agreed

Item	Document	NCC Position	Highways England Response	Status
			<i>shown to be present, or where there is a reasonable likelihood of it being present ... the relevant parts of the relevant works must cease until a scheme of protection and mitigation measures has been submitted to and approved in writing by the Secretary of State."</i>	
7.11	Updated Biodiversity Air Quality DMRB Sensitivity Assessment [REP3-010]	<p>Northumberland County Council confirm that they would naturally defer to the advice of Natural England as the statutory body for nature conservation.</p> <p>Northumberland County Council, Natural England and Highways England have engaged regarding the provision of funding for habitat improvements as compensation for the significant effects concluded in relation to Borough Wood LNR/ancient woodland and Well Wood ancient woodland (as detailed in Updated Biodiversity Air Quality DMRB Sensitivity Assessment [REP3-010] (and as updated at Deadline 10).</p> <p>Funding will be secured through a Legal Agreement between Highways England and Northumberland County Council. As such, Northumberland County Council agree that, subject to the finalisation if this legal agreement sufficient compensation will be provided to address the impacts to Borough Wood LNR/ancient woodland and Well Wood ancient woodland as a result of changes in air quality.</p> <p>Northumberland County Council has agreed the terms, and anticipate that this legal agreement can be finalised by Deadline 11.</p>	<p>Highways England will provide appropriate compensation for the significant effects to Borough Wood LNR/ancient woodland and Well Wood ancient woodland as concluded in Updated Biodiversity Air Quality DMRB Sensitivity Assessment [REP3-010] (and as updated at Deadline 10).</p> <p>This will be delivered through the legal agreement, the terms of which are agreed and which will be completed in the week beginning 5th July.</p>	Agreed
8	Road Drainage and the Water Environment			
8.1	Chapter 10 (Road Drainage and the Water Environment) of the ES [APP050 and APP051]	NCC accepts that the submitted documents and assessments have undertaken modelling of all the relevant watercourses for which the new highway will cross and will impact upon. All modelling has been in accordance with national policy and best practice guidance. This modelling shows that with appropriate design and mitigation flood risk will not increase on or offsite as a result of the development.	Agreed	Agreed
8.2		NCC has reviewed the submitted information in relation to surface water and is satisfied with the proposed flood risk mitigation measures.	Agreed	Agreed
8.3		The submitted documents and assessments have looked at the disposal of surface water from the new highway. With this aspect it needs to be ensured that the rate and volume of water leaving the development / appropriate catchment is no greater than previous.	Agreed	Agreed
8.4		In relation to the River Coquet, NCC is satisfied with the proposals and mitigation in relation to flood risk and drainage.	Agreed	Agreed
8.5		The applicant's intention is that the Rock South Farm access road is to be for adoption by NCC. There are two options to be progressed in order to demonstrate to NCC the suitability of the road for adoption.	The Applicant provided NCC with drainage details in relation to both sections of the access road on 10/06/2021. The details submitted reflected the level of	Agreed

Item	Document	NCC Position	Highways England Response	Status
		<p>The access road has been split into two sections, north and south. Over the northern section positive drainage with filter drains and ditches can be provided to allow for controlled discharge to the local watercourse. Over the southern section the relatively flat topography would make it difficult to provide a piped outfall to the watercourse. An infiltration solution to discharge water is proposed instead with the carriageway lifted to avoid low spots.</p> <p>These options will be confirmed at detailed design with site surveys.</p> <p>NCC agree with the written principles but reserve our position until we have seen the proposals in full and the results of the monitoring of the “as built” Scheme.</p>	<p>drainage detail provided reflected that for details previously provided to NCC in relation to the other roads forming part of the Scheme. Further, an updated Drainage Strategy Report [REP6-020 and REP6-021] has been submitted at Deadline 10, which includes details in relation to the access road.</p> <p>It is agreed that the ultimate outcome is still for NCC adoption with the following steps:</p> <ol style="list-style-type: none"> Improvements to earthworks to address low spots within Order limits eliminating risk of water damage to the road pavement Northern section agreed for detailed design for discharge to local watercourse; Southern section to be drained by Infiltration subject to testing of ground conditions and detailed design. Testing to be undertaken on site by Principal Contractor; Results and detailed design development to be shared with NCC; Alternative positive drainage design being investigated should site testing rule out the southern infiltration solution. Discussion in principle with Rock Estate to undertake, by Agreement, enhanced drainage provision outside the Order limits but subject to site survey <p>Monitoring of drainage system on track performance to start once new access road is operational (>1yr monitoring during construction) and for full 1yr maintenance liability period after Scheme opens to give an overall increase in the drainage system liability period to >2yrs.</p>	
9	Traffic and transport			
9.1	New local roads to be adopted	The trunk road and associated junctions slip roads and their soft estate to remain with the Applicant. Private Means of Access will stay with the appropriate landowner.	NCC agreed principles as shown as hatched Orange in the Proposed Highway Adoption and Maintenance Responsibilities drawing [REP6-009]. Exception is for Rock South Farm Access Road, who's adoption is subject to satisfactory conclusion of outstanding drainage provision.	Agreed

Item	Document	NCC Position	Highways England Response	Status
9.2		The Council is content that the pathways and junctions which were used for the survey were appropriate to assess the way in which the network was being used by walkers, cyclists and horse-riders. Based on the results of the survey undertaken over the six days at the various locations the Council is satisfied that the level of use is commensurate with our own anecdotal knowledge of use of these types of rights of way in particular locations	Agreed	Agreed
10	Design			
10.1	Design speed / speed limit	New side roads leading from the Charlton Mires Junction are designed in line with NCC's Residential Roads and Footpaths in Northumberland design guidance but instead of a 20mph speed limit the national speed limit is appropriate	<p>It is acknowledged that rather than imposing lower speed limits on the long straight or large radii bends, agreed traffic calming features could be incorporated as part of detailed design.</p> <p>Further discussions on 17/12/20 with NCC agreed that the national speed limit is appropriate, and any traffic calming features will be agreed at detailed design.</p> <p>The Traffic Regulations Measures Plans [REP6-007] were updated for Deadline 6, and the Draft DCO [REP6-014] is to be updated for Deadline 8.</p>	Agreed
10.2	Maintenance boundaries – at junctions, soft estate	<p>All infrastructure relating to the new trunk road and its supporting earthworks and soft estate to remain under the maintenance of the Highways England.</p> <p>Agreed, subject to receiving the formal letter from HE.</p> <p>NCC accept that a MoU is an appropriate means of addressing this issue. NCC is now in receipt of an updated Memorandum of Understanding (dated and received 1 July 2021) but has not yet had opportunity to fully review the document.</p> <p>As such the position is “not agreed” at the close of the examination, although NCC and Highways England will continue to liaise to resolve this issue directly as part of the detailed design process.</p>	<p>Critical infrastructure relating to the new trunk road and its supporting earthworks and soft estate will remain under the maintenance of the Applicant. Other earthworks supporting local access roads and management of its soft estate will form part of the handover to the local highway authority.</p> <p>Further principles defining the embankments and cuttings have been agreed and are set out in Appendix TT.3 of the Applicant's Response to the ExA's First Written Questions [REP1-049].</p> <p>Detention basins associated with servicing the trunk road will be the responsibility of the Applicant. There are two basins DB17a and DB17b which service Bywell Road and the new de-trunked link road respectively. These roads are to be adopted by the Local Highway Authority, while the basins would be maintained by the Local Authority.</p> <p>It was agreed at a meeting on 16/04/21 that the details around the maintenance limits of adoption could be agreed at detailed design. However, a note is to be produced during the DCO examination period to state the agreed methodology of determining adoption and to</p>	Not Agreed.

Item	Document	NCC Position	Highways England Response	Status
			<p>act as a record of what has been Agreed at this stage and what can be agreed at the detailed design stage.</p> <p>A draft methodology of determining adoption and maintenance liability, and to act as a record of what has been agreed at this stage, was shared prior to a meeting on 19/05/2021. The meeting on 28/5/21 agreed the MoU with two minor amendments. This has revised after the meeting on 25/06/21 and issued under formal letter by HE.</p> <p>NCC and Highways England will continue to liaise directly to resolve this issue as part of the detailed design process.</p>	
10.3		NCC has no concerns over the access to and from the A1 from the current Causey Park junction with vehicles to and from the Widdrington Road approach being able to use the de-trunked and new local road connections to the dualled A1 without any significant diversion over the current access as both the West Moor and Fenrother junctions are all-direction grade separated junctions	Agreed	Agreed
10.4	Maintenance boundaries	NCC raised issues surrounding the stopping up of highways near Detention Basin 20 and Highlaws Junction, particularly with regard to ownership following completion of the scheme and whether this should be covered off in the DCO.	The Applicant updated the Rights of Way plans [REP6-006] and associated DCO schedules [REP6-010 and 011] at Deadline 6.	Agreed
10.5	Maintenance boundaries – adoption	East Linkhall Access Road to be widened from 4.5m wide single-lane with passing bays to become 6.0m wide two-lane carriageway.	The Applicant agrees – this change was allowed for within the Order limits set. Update to the General Arrangement Plans was made at Deadline 5 and updated to include drainage at Deadline 6 [REP6-005].	Agreed
10.6	Maintenance boundaries – adoption	Length of existing road to the north of East Linkhall Access Road tie-in (Ch.60200 to Ch.603000) is to be de-trunked – dDCO Schedules to be updated accordingly. NCC ask that Shipperton Bridge to be maintained by HE, similar to the arrangement at Priest Bridge on Part A. Alternatively, the adoption could end south of Shipperton Bridge, with a turning head provided at the end of the adopted length of road.	The ownership of this land was investigated by the Applicant. The length of new access road for adoption to be updated on the General Arrangement plans [REP8a-002]. The final extent and the detail of a turning head was agreed by NCC on 28/05/2021. The ownership of the land and the maintenance arrangements for Shipperton Bridge are to remain with the Applicant to resolve.	Agreed
10.7	Maintenance boundaries – adoption	West Linkhall Access Road pinch point – length and width of single lane section of road to be reduced if possible.	The Applicant agrees that the carriageway width should be reduced to 3.9m, and an updated Proposed Highway Adoption and Maintenance Responsibilities Plan was submitted at Deadline 6 [REP6-009].	Agreed

Item	Document	NCC Position	Highways England Response	Status
			The length of the single carriageway section was investigated and reduced to 125m in length.	
10.8	Maintenance boundaries – adoption	Turning head to be provided at northern extent of West Linkhall Access Road.	The Applicant agrees and an updated Proposed Highway Adoption and Maintenance Responsibilities Plan was submitted at Deadline 6 [REP6-009].	Agreed
10.9	Maintenance boundaries – adoption	Rock South Farm Access Road carriageway width to be reduced from 4.5m.	The Applicant agrees. Carriageway width to be reduced to 3.9m. No changes have been made to the design at this stage but will be incorporated at detailed design. Drainage for this Access Road is discussed at Point 8.5 above.	Agreed
10.10	Maintenance boundaries – adoption	Positive drainage to be provided on access roads for East Linkhall, West Linkhall and Rock South Farm. Agreed, subject to seeing the information set out in NCC's response at 8.5.	The Applicant confirms that West Linkhall Access Road will be positively drained through the reuse of existing drainage on the repurposed A1 carriageway. The Scheme design has been updated to include positive drainage for East Linkhall Access Road. The relevant DCO Plans were updated for Deadline 6 [REP6-009]. Provision of positive drainage for Rock South Farm Access Road is accepted along the northern section with filter drains and ditches providing for a controlled discharge to the existing watercourse. An infiltration solution for the southern section will be subject to site surveys, detailed design, and an operational maintenance period before adoption, with a fallback of discharging to local watercourse (if technically feasible) outside the Order limits should site surveys rule out the proposed solution. More details are provided in item 8.5 above.	Agreed
10.11	Condition of de-trunked section for handover	NCC require confirmation that the road has been maintained to an appropriate standard, and that any required interventions be carried out prior to handover. The relevant survey information and asset records will need to be provided to NCC so that this can be confirmed.	It has been agreed that the Applicant is to share existing records of all assets on de-trunked section with NCC. The Applicant and NCC have agreed that condition surveys of the road pavement and footways will be provided, as well as CCTV surveys of existing drainage assets and culvert surveys.	Agreed

Item	Document	NCC Position	Highways England Response	Status
			<p>NCC are undertaking, once all records are received, a gap analysis to identify areas where condition or records of the asset are an issue.</p> <p>The Applicant agrees that their Operations Directorate for the area are to prove that the section of road to be de-trunked is in a safe, serviceable, adoptable standard, and that any issues with the condition of assets will be resolved prior to handover to NCC.</p> <p>Details of the above items are to be included in future revisions of the Maintenance Methodology MOU. A follow up meeting will be arranged to review the output of the gap analysis of the de-trunked section.</p>	
10.12	Condition of de-trunked section for handover	NCC reiterate their concern, previously discussed in several Hearings, that the width of the de-trunked section of the A1 could encourage higher speeds and be a safety issue when this stretch becomes a local road. Their TT3.2 response [REP8-028] states that the safety issue with the de-trunked A1 relates to speed of traffic due to the unnecessarily wide width of carriageway (as per the Stage 1 Road Safety Audit referenced in REP4-074). The Council strongly believes that a reduction to the road width of the de-trunked section to 7.3m should form part of the works required by the Development Consent Order. Separately, in addressing this safety issue in reducing the width of the carriageway, this offers the opportunity to provide the NMU route (footway/cycleway) within a widened verge area created by narrowing the carriageway.	<p>The Applicant agrees with NCC that the provision of a cycleway would not necessarily resolve the potential for increasing vehicle speeds on the proposed de-trunked section of the A1 as identified in the Stage 1 Road Safety Audit (RSA).</p> <p>The Applicant reiterates its previously stated position that if there is a requirement to reduce speeds on the de-trunked A1 post-handover then it is entirely within NCC's powers, as the relevant highway authority, to do this (i.e. by reducing the speed limit, introducing new road markings or introducing speed enforcement measures.) There is, however, no justification for requiring a cycle lane to be provided on the de-trunked A1 to mitigate the impact of the Scheme/</p> <p>In summary the Applicant does not agree that any changes to the A1 are required as part of the handover process.</p>	Not Agreed
11	Effects on Motorised Road Traffic			
11.1		In relation to the impact on road safety away from the Strategic Road Network, the proposals will make the A1 a more attractive travel option and those travellers who wish to avoid actual or perceived delays, especially in the summer months, will use the upgraded sections removing traffic from unsuitable routes on the Local Road Network.	Agreed	Agreed
11.2		NCC considers that the single carriageway nature of the A1 has contributed to Alnwick and places further north having a much more remote character with reduced opportunity to access work and key services offered by the Tyneside conurbation.	Agreed , the Scheme will help to address this issue.	Agreed

Item	Document	NCC Position	Highways England Response	Status
11.3		In relation to the Alnwick to Ellingham section (Part B), there are road safety benefits from removing the local traffic from the Strategic Road Network in particular through the provision of the new Local Access Roads to East and West Linkhall as well as new road to Rock South Farm.	Agreed , the Scheme will help to address this issue.	Agreed
11.4		These positive impacts upon Road Safety can only be fully confirmed once all additional points of clarification and additional information in relation to the development as requested from Highways England and their consultant and contractor partners is received and agreed.	Agreed, but it is common ground that the Scheme will improve highway safety in the area.	Agreed
11.5		<p>NCC would like to see the following links, identified in Matthew Payne's email to the Applicant dated 14/05/21 and 27/05/21 included in the post-scheme monitoring:</p> <ul style="list-style-type: none"> – The link through Hebron village showing people using this route over the Morpeth By-Pass from Pegswood; – Additional trips on St Leonards Lane from Mitford; and – Routing from A697 to A1 going cross country from Whittingham to existing A1 dual at Shilbottle. 	<p>Both parties agree that these are likely to be anomalies in the traffic modelling.</p> <p>The Applicant initially believed that the increases were relatively low, as are the do minimum flows, and did not consider they were sufficient to warrant concern. However, monitoring has been agreed between the parties.</p> <p>It is agreed to be a period just before construction begins and then one and five years post opening in accordance with DfT guidance.</p> <p>Should the monitoring prove the flows do reach the growth predicted by the model then the Applicant has agreed for a commuted sum to be provided for mitigation by the local highway authority.</p> <p>Traffic monitoring to be secured in the Outline CEMP to be updated at Deadline 10.</p>	Agreed
12	Effects on the Public Rights of Way (PRoW) network and on cyclists, pedestrians and horse riders			
12.1	Extents and widths of new rights of way, diverted rights of way and stopping up of existing rights of way	NCC proposed numerous changes to the Public Rights of Way and Access Drawings [REP2-003] and the relevant schedules in the Draft DCO [REP2-004 and 005] following their review of the DCO Application.	<p>The proposed changes were considered by the Applicant and responded to via direct communication as well as through the Applicant's Comments on Responses to Written Questions for Deadline 2. For details refer to Applicant's Comments on Responses to Written Questions – Appendix A – Public Rights of Way Response [REP2-021]. Both the plans and dDCO [REP2-004 and 005] were updated to reflect the proposed changes and resubmitted for Deadline 2.</p> <p>NCC confirmed at a meeting held on 17/02/21 that almost all issues raised in relation to the PRoWs have</p>	Agreed

Item	Document	NCC Position	Highways England Response	Status
			<p>now been resolved, with just a couple of minor outstanding issues still to be addressed.</p> <p>NCC is content for the proposed ProW widths to be captured in the SoCG, as long as this is agreeable with the Examiner. The standard widths employed by NCC are as follows:</p> <ul style="list-style-type: none"> – The preferred width for a public footpath is 1.5 metres or 2.0 metres where the public footpath is proposed to be fenced or hedged on each side. – The preferred width for a bridleway is 3 metres. <p>It is noted that these widths refer to the legal width and represent the minimum gap between any boundary features (fence, wall trees, hedge etc) along the length of the right of way. Any made up path or bridleway which is being physically created may have a different width and NCC are open to discussion with respect to any specific proposals for individual rights of way where there is physical creation on the ground.</p>	
12.2	Statement in the Hearings	The A1 currently acts as a barrier to East / West journeys in the region, and the Scheme will improve East / West connectivity.	Agreed.	Agreed
12.3	NMU Provision on de-trunked section	<p>NCC are looking for the inclusion of a segregated cycle path on the 2.5km de-trunked length of the old A1 that does not currently have NMU provision with the upgrade and connections for NMUs along the remaining length to be de-trunked.</p> <p>NCC have also identified a full north-south connectivity opportunity from Tritlington to Morpeth. Both of these aspects are annotated in plan included as Appendix A (below).</p>	The Applicant has confirmed that the NMU provision already included within the DCO satisfactorily addresses the Scheme impacts. The creation of additional NMU facilities is outside the DCO and requires separate funding.	Not Agreed
		NCC has submitted an alternative text for the draft DCO [REP5-034 and 035] that is considered to deliver the NMU route within Part A of the scheme.	<p>The Applicant has reviewed the draft text but considers that the requested NMU route is not deliverable within the Scheme Limits.</p> <p>The Applicant considers that the DCO satisfactorily addresses the Scheme impacts.</p>	Not Agreed
12.4	Population and Human Health	It is considered that the impacts of the Scheme on Population and Human Health have been fully assessed. However, NCC would like to see a summary of impacts on communities within the Population and Human Health study area (1km from the Scheme) that was requested by NCC.	The Applicant has provided the information in the additional cumulative impact.	Agreed

Item	Document	NCC Position	Highways England Response	Status
13	Construction Environmental Management Plan			
13.1		An Outline Construction Environmental Management Plan [APP-346] has been submitted with the application. This document provided is an appropriate vehicle for identifying the mitigation measures for the Scheme that will be included within the final CEMP.	Agreed. The CEMP will be kept under review.	Agreed
13.2		<p>NCC's position is set out in the Post-Hearing note submitted at Deadline 6 [REP6-050].</p> <p>Subject to a greater level of narrative being added to the Outline CEMP, confirming the commitments, philosophy and timings of the measures that will be contained in the detailed LEMP (whether a standalone documents, which is NCC's preferred position, or as part of the wider CEMP, which is the Applicants position) NCC is content that an Outline LEMP is not required as part of the DCO application.</p> <p>Whether as a standalone document or as part of a wider CEMP, the wording of Requirement 17 must not give discretion to the Applicant to choose whether or not to submit a LEMP without giving NCC the opportunity to refer the matter to the Secretary of State.</p>	<p>The Applicant notes that NCC accept that an Outline LEMP is not required as part of the DCO application.</p> <p>An updated Outline CEMP setting out the commitments, philosophy and timings of the proposed LEMP measures was submitted to NCC and the examination at Deadline 6 [REP6-025].</p> <p>The Applicant is discussion the wording of Requirement 17, as set out at Item 19 in Table 3.1, above.</p>	Not Agreed
14	Construction Traffic Management Plan			
14.1	7 day working during the works	NCC initially suggested encouraging 7 day working (subject to other factors). However, following discussions with The Applicant, they now accept that this is not appropriate.	<p>The Applicant has set out the reasons why seven day working is not appropriate:</p> <p>Any traffic management required on the network will be left in place for the duration of the requirement – supported by 24/7 inspection and maintenance provision.</p> <p>For wider activities 7-day working is not supported unless for a specified fixed duration activity. This is not only to manage workforce safety and ensure the Applicant does not impose fatigue, but also to afford a regular period of respite and break form the works to all locally affected stakeholders.</p> <p>Where there is a significant benefit or need to complete 7-day operations this will be planned as a specific work item with those affected.</p> <p>NCC are in agreement with the Applicant's position stated above.</p>	Agreed

Item	Document	NCC Position	Highways England Response	Status
14.2	Consultation in relation to road closures during the works	The requirement to close side roads and the A1 will be subject to consultation with NCC. NCC need to ensure that consultation is timely to allow for any re-planning of their works that may be affected.	<p>The Applicant has confirmed the following:</p> <p>When the construction programme is more mature (and no later than 6 months ahead of construction start) the main contractor will arrange a meeting with key stakeholders (NCC, emergency services etc) to introduce key personnel from our team and provide:</p> <ul style="list-style-type: none"> – An overview of the TTM proposals and sequence of works, – Key switches in the first quarter, – Establish agreed contact points for comms between the main contractor and each stakeholder, – Gather feedback on proposals and refine and develop and necessary. <p>This will be repeated at 3 months ahead of construction and then 1 month ahead providing updates and addressing any new concerns.</p> <p>When construction starts the main contractor will operate monthly TM Forums whereby, they will:</p> <ul style="list-style-type: none"> – Present the proposed works for the coming quarter at high level (and the specific details of any forthcoming significant switches in that period); – Seek to identify any potential clashes with road space for works or diversion planning for that quarter to be assessed and co-ordinated out of the meeting; – Present detailed plans for any switches in the coming month; – Review any concerns from the previous month; and – Discuss any forthcoming events/embargoes/etc. to ensure they plan accordingly. <p>In the meantime, the main contractor's TM Managers will be available for any concerns from key stakeholders between the regular contact points of TM Forums.</p>	Agreed

Item	Document	NCC Position	Highways England Response	Status
			NCC are in agreement with the Applicant's position stated above.	
14.3	TTROs for reduced speed limits during the works	TTROs would be required to reduce the speed limit on both the A1 and local road network (managed by NCC) as part of the Scheme. The main contractor will define the extents of the speed restrictions and progress the TTROs with the Applicant and NCC to ensure these are in place prior to any temporary speed restrictions being imposed - restrictions will be entered onto One network by the Streetworks team.	<p>The Applicant agrees and has confirmed the following:</p> <p>Proposed TTROs for the Scheme will be introduced in the main contractor's initial meeting (6 months prior to construction start) and then discussed and developed together prior to any formal submission.</p> <p>The main contractor will also arrange to populate other systems at the relevant time as agreed with NCC (i.e. at the time of formal TTRO submission, or at specified number of weeks ahead). This will be led by the main contractor's TM Manager.</p> <p>NCC are in agreement with the Applicant's position stated above.</p>	Agreed
14.4	Extended closures / weekend closures during the works	Para. 2.6.24 of the CTMP refers to extended closures (possibly some Friday to Monday full closures). Full weekend closures may cause a lot of pressure on NCC network. There are only 4 extended closures planned – NCC want assurances that this will be the case.	<p>The Applicant has confirmed the following:</p> <p>The main contractor does not currently anticipate needing more than 4 extended closures to deliver the works.</p> <p>Should this change as their planning develops, they will engage with NCC and all affected stakeholders through specific meetings at the earliest opportunity to discuss the proposal, the need and ensure sufficient time for robust communication and stakeholder liaison with all affected parties.</p> <p>NCC are in agreement with the Applicant's position stated above.</p>	Agreed

Item	Document	NCC Position	Highways England Response	Status
14.5	Communication of journey times during the works	In respect to para. 2.6.29 of the CTMP, NCC initially stated a preference for the quoted journey time to be expressed as the additional time the journey will take. However, following discussions with The Applicant, they now accept that this is not appropriate.	<p>The Applicant has confirmed that when the main contractor displays journey times for diversion routes on their pVMS they are governed by Highways England VMS policy. Their TM Manager will look to provide the best information to the travelling public whilst ensuring they still comply with Highways England policy.</p> <p>Highways England VMS policy does not allow the quoted journey time to be expressed as the additional time the journey will take. NCC are in agreement with the Applicant's position stated above.</p>	Agreed
14.6	Coordination meetings prior to and during the works	NCC concerned over the regularity, scope and attendees of coordination meetings.	<p>The Applicant has confirmed the following:</p> <p>When the construction programme is more mature (and no later than 6 months ahead of construction start) the main contractor will arrange a meeting with key stakeholders (NCC, emergency services etc) to introduce key personnel from our team and provide:</p> <ul style="list-style-type: none"> – An overview of the TTM proposals and sequence of works, – Key switches in the first quarter, – Establish agreed contact points for comms between the main contractor and each stakeholder, – Gather feedback on proposals and refine and develop and necessary. <p>This will be repeated at 3 months ahead of construction and then 1 month ahead providing updates and addressing any new concerns.</p> <p>When construction starts the main contractor will operate monthly TM Forums whereby, they will:</p> <ul style="list-style-type: none"> – Present the proposed works for the coming quarter at high level (and the specific details of any forthcoming significant switches in that period); – Seek to identify any potential clashes with road space for works or diversion planning for that quarter to be assessed and co-ordinated out of the meeting; 	Agreed

Item	Document	NCC Position	Highways England Response	Status
			<ul style="list-style-type: none"> – Present detailed plans for any switches in the coming month; – Review any concerns from the previous month; and – Discuss any forthcoming events/embargoes/etc. to ensure they plan accordingly. <p>In the meantime, the main contractor's TM Managers will be available for any concerns from key stakeholders between the regular contact points of TM Forums.</p> <p>The revised CTMP issued at Deadline 1 [REP1-025] was updated in response to NCC's comment and was issued at Deadline 3 [REP1-025].</p> <p>NCC are in agreement with the Applicant's position stated above.</p>	
14.7	Traffic counts	NCC initially expressed a wish for traffic counts on informal diversion routes, prior to and during the work, to assess/quantify any increased rat running. However, following discussions with The Applicant, NCC now accept that the appropriate position is to provide extra signage with reactionary traffic counts as necessary.	<p>The Applicant has confirmed the following:</p> <p>The main contractor will provide additional supportive signage to discourage rat running and encourage people following signed diversions only. Reactionary traffic counts may be used if necessary.</p> <p>HE will continue to engage with NCC regarding construction impacts and the monitoring of noise, air quality and traffic flows at key locations. The CTMP will continue to be developed based on these discussions.</p> <p>NCC are in agreement with the Applicant's position stated above.</p>	Agreed
14.8	Preparation of the Detailed Local Operating Agreement	NCC expressed wish for this to start as soon as possible so that the process is not rushed.	<p>The Applicant agrees and has confirmed the following:</p> <p>The main contractor agrees and would like to start the preparation of the Detailed Local Operating Agreement at the earliest practical opportunity to avoid any rush. The proposal would be to engage from Easter time 2021 to start to draft allowing circa 1 year for completion and reviews.</p>	Agreed

Item	Document	NCC Position	Highways England Response	Status
14.9	Impact of organised and “informal” diversion of traffic during the works	There is a concern over the impact of both the organised and “informal” diversion of traffic during the works. Particular areas of concern include the A697 through Longhorsely and Longframlington as this is the obvious diversion for traffic who may experience queues entering the Traffic Management at the Northgate junction, similar to what occurs during summer peak periods when concertina or phantom queuing can occur as vehicles slow from the dual carriageway into the single carriageway currently.	<p>The Applicant has confirmed the following:</p> <ul style="list-style-type: none"> – The main contractor has the use of mobile VMS and technology that has the capability to alert road users to journey times through the works; this should inform them that phantom queues are just that and that journey time is still better to remain on the A1. They can trial the locations of these and adjust as trials suggest, seeking to avoid unnecessary pressures being put on the potential informal diversion routes. – As described in the Case for the Scheme [APP-344], traffic modelling of the construction scenario was undertaken using the SATURN model, in order to calculate the monetised disbenefits associated with delays during the construction works. The model forecasts that the majority of A1 traffic (around 90%) will remain on the A1 during the construction works, with a small forecast increase in traffic flows along the A697. During the morning peak hour, the model forecasts an additional 29 vehicles northbound and 84 vehicles southbound on the A697 passing through Longhorsley and Longframlington. During the evening peak hour, the model forecasts an increase of 30 vehicles northbound and 40 vehicles southbound. Given that the forecast increase is below two vehicles per minute, this is not considered likely to have a significant adverse impact at these locations. <p>NCC are in agreement with the Applicant’s position stated above.</p>	Agreed

Item	Document	NCC Position	Highways England Response	Status
14.10	Impacts of the diversion routes on villages during the works	There are concerns over the impacts in all villages on the diversion routes, both formal and informal, especially during the full weekend closures and whether any temporary mitigation is therefore required.	<p>The Applicant continues to liaise with NCC regarding the impact of redistributed traffic on the local road network and provided the following comments to NCC's response to written question TT1.18 at Deadline 2 (see Table 1-5 of [REP2-020]):</p> <ul style="list-style-type: none"> – Section 2.6.36 of the CTMP [REF] confirms that signage will be erected to confirm the official diversion route and deter traffic from passing through sensitive areas. – The model referred to in the Case for the Scheme [APP-344] forecasts that the majority of A1 traffic (around 90%) will remain on the A1 during the construction works, with a small forecast increase in traffic flows along the A697. During the morning peak hour, the model forecasts an additional 29 vehicles northbound and 84 vehicles southbound on the A697 passing through Longhorsley and Longframlington. During the evening peak hour, the model forecasts an increase of 30 vehicles northbound and 40 vehicles southbound. Given that the forecast increase is below two vehicles per minute, this is not considered likely to have a significant adverse impact at these locations. <p>NCC are in agreement with the Applicant's position stated above.</p>	Agreed

Appendix A

PEDESTRIAN - CYCLE LINK MORPETH TO FELTON

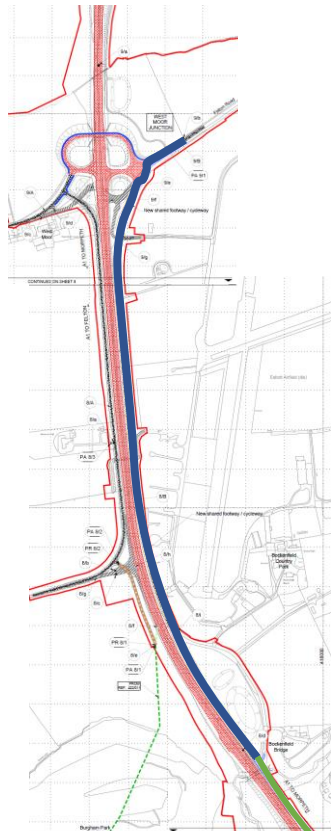

Footway/Cycleway as shown
On PRow and Access Plans
Constructed in accordance
With NCC Cross Section

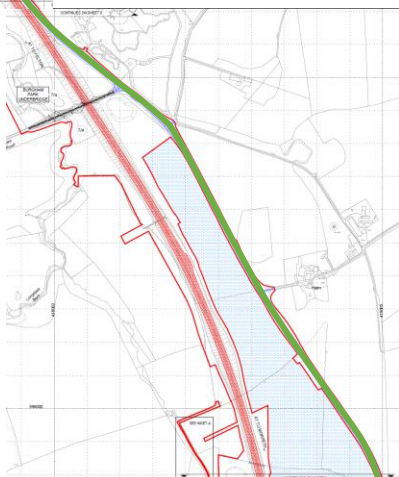

New Footway/Cycleway to
Continue from Northern
Section Constructed to NCC
Cross Section Requirements

Footway connection
from overbridge footway
to existing footway on
de-trunked A1



Existing Footway to be
Incorporated into New
Footway/Cycleway to NCC
Cross Section Requirements

Footway connection
from junction footway to
existing footway on de-
trunked A1

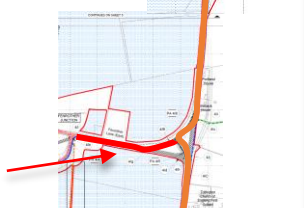

New Footway/Cycleway to
Continue Constructed to NCC
Cross Section Requirements

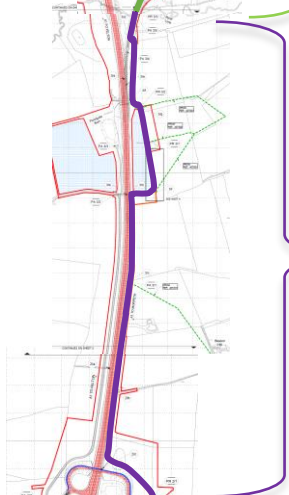

New Footway/Cycleway to
Utilise Existing and Proposed
PRow Routing to Continue
Linkage - design to be agreed



New / Existing Footway
Be Widened to Allow
Footway/Cycleway
Designation

Link to avoid Private Accesses

New Footway/Cycleway to
Utilise Existing and Proposed
PRow Routing to Continue
Linkage - design to be agreed

© Crown copyright 2021.

You may re-use this information (not including logos) free of charge in any format or medium, under the terms of the Open Government Licence. To view this licence:

visit www.nationalarchives.gov.uk/doc/open-government-licence/

write to the **Information Policy Team, The National Archives,**

Kew, London TW9 4DU, or email

psi@nationalarchives.gsi.gov.uk.

This document is also available on our website at www.gov.uk/highways

If you have any enquiries about this document

A1inNorthumberland@highwaysengland.co.uk

or call **0300 470 4580***.

*Calls to 03 numbers cost no more than a national rate call to a 01 or

02 number and must count towards any inclusive minutes in the

same way as 01 and 02 calls.

These rules apply to calls from any type of line including mobile, BT, other fixed line or payphone. Calls may be recorded or monitored.

Registered office Bridge House, 1 Walnut Tree Close, Guildford GU1 4LZ

Highways England Company Limited registered in England and Wales number 09346363